

University Publications

Sixty-Sixth Year—No. 1

Alfred University

FOUNDED 1836

Reports, 1900-1901

PUBLISHED BY ALFRED UNIVERSITY

NOVEMBER, 1901

Entered at the Post-office at Alfred, N. Y., as Second Class Matter

INDEX

Acknowledgement of Gifts	33
Alfred Academy	4, 15, 54
Alumni Association (Appendix C)	66-68
Athletic Field	36
Babcock Fund, E. Lua	41
Bequests, Forms of	47
Board of Trustees of the Seventh-day Baptist Memorial Fund	62
Budget for 1901-02	31
Degrees	5'
Education Society (Appendix A)	53
Endowment and Property	38
Expenses for Ten Years	12
Faculty	4, 5
Flint, Weston	65
Gifts	46
Illustrations	1, 65
Janitors and Supplies	42
Librarian's Report	13
Memorial Board (Appendix B)	54
New York State School of Clay-Working and Ceramics	69
Powers, Mrs. Julia Maria Rogers	1
President's Report	5
Register of Students	11
Registrar's Report	10
Treasurer's Report	21-31
Trustees of the University	2
Scholarships	48
Seventh-day Baptist Education Society	53
State School Report	16
Wooden Estate and Fund, Peter	40

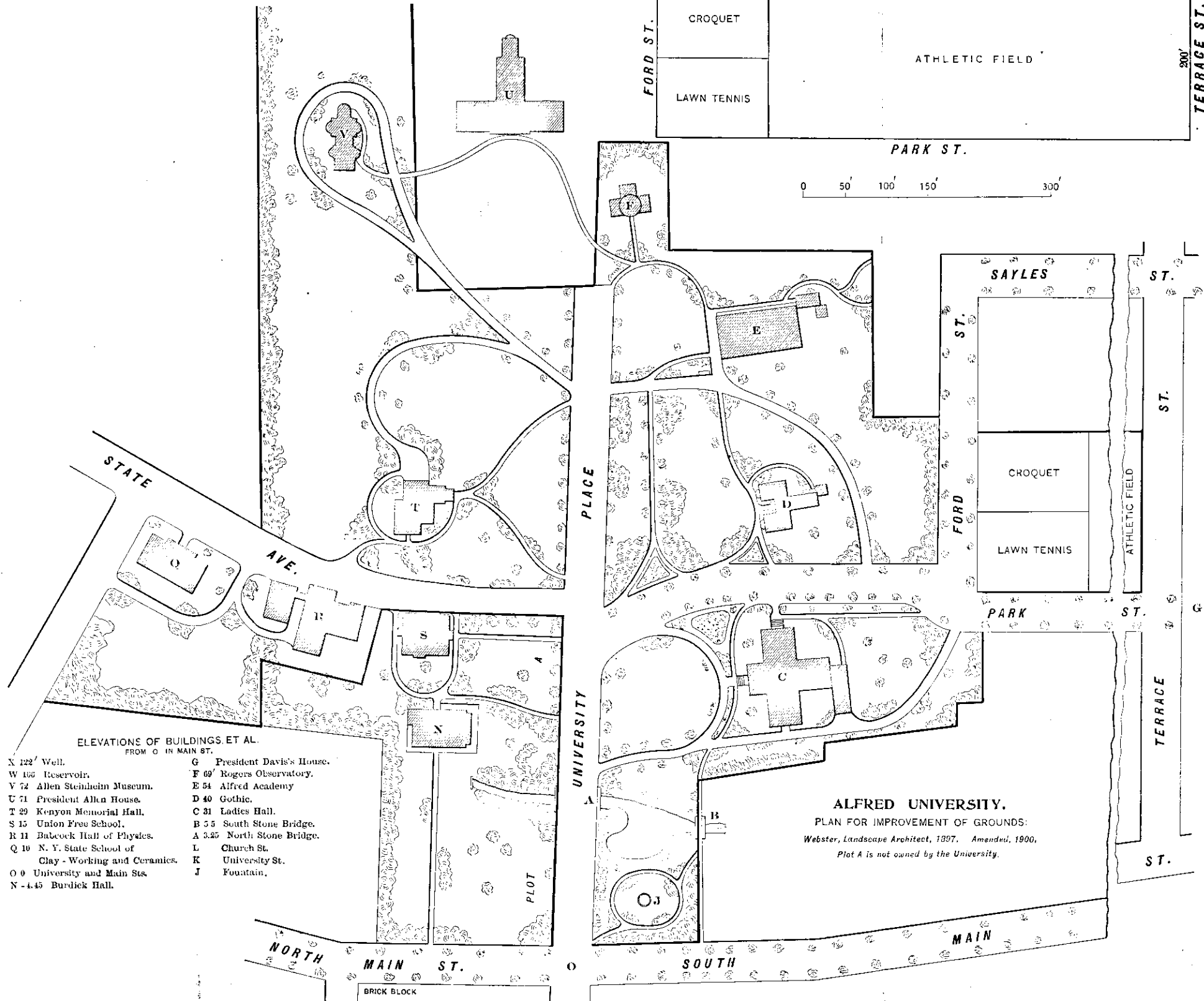



MRS. JULIA M. ROGERS POWERS.

MRS. JULIA MARIA ROGERS POWERS

Mrs. Julia Maria Rogers Powers, who left a bequest of five hundred dollars to Alfred University, was a sister of the late Prof. Wm. A. Rogers, toward whose memorial the gift was presented, it being designated to apply on the Wm. A. Rogers Professorship of Astronomy.

Mrs. Powers was a daughter of David P. and Mary Ann Rogers; was born at Waterford, Conn., Oct. 4, 1834, and died May 3, 1899. She was married to Geo. H. Powers with whom she lived a happy married life of 36 years.

First of all a Christian, Mrs. Powers was a leader and enthusiastic worker in missionary, philanthropic and educational enterprises.

In early life, she was a student in Alfred University. She always retained a love for her Alma Mater and a desire to render it useful service. This desire she put into concrete form by her generous benefaction to Alfred University.

BOARD OF TRUSTEES

Term expires in June, 1902.

Hon.	NATHANIEL M. HUBBARD, Ph. D., LL. D., '52,	Cedar Rapids, Iowa.
	CHAS CLARENCE CHIPMAN, Acct. B., '86,	New York City.
Hon.	JOHN N. DAVIDSON, E. M., '54,	Wiscoy.
Rev.	LEANDER E. LIVERMORE, A. M., D. B., '66,	Dunellen, N. J.
	WILLIAM C. BURDICK,	Alfred.
Rev.	DARIUS R. FORD, D. D., '48,	Elmira.
	WILLIAM H. CRANDALL,	Alfred.
Mrs	GEORGE H. BABCOCK,	Plainfield, N. J.
	AMOS A. SHAW,	Alfred.
Capt.	R. EMMETT BURDICK,	Cleveland, Ohio.
	EDGAR H. COTTRELL,	New York City.

Term expires in June, 1903.

Hon.	DANIEL LEWIS, A. M., Ph. D., M. D., '6g,	New York City.
Hon.	SEYMOUR DEXTER, A. M., Ph. D., '64,	Elmira.
	JOHN J. MERRILL, Ph B., '84,	Alfred.
	LORENZO D. COLLINS,	Alfred.
	VERNON A. BAGGS,	Alfred.
	JOSEPH M. TITSWORTH,	Plainfield, N. J.
	EDWIN S. BLISS,	Alfred.
Rev.	LESTER C. RANDOLPH, A. M., B. D.,	Alfred.
	HERBERT G. WHIPPLE, A. B., '87,	New York City.
	HENRY P. SAUNDERS, M. D.	Alfred.
	ELWOOD E. HAMILTON, Ph. B , '84,	Alfred.

Term expires in June, 1904.

Hon.	ALBERT B. COTTRELL,	Alfred.
Rev.	OSCAR U. WHITFORD, A. M., D. D , '63,	Westerly, R. I.
	CORLISS F. RANDOLPH, A. M., '88,	Newark, N. J.
Supt.	HENRY M. MAXSON, A. M.	Plainfield, N. J.
	ORVILLE M. ROGERS,	Alfred.
	SILAS C. BURDICK, E. B., '58,	Alfred.
Hon.	GEORGE H. UTTER, A. M.,	Westerly, R. I.
Pres.	BOOTHE COLWELL DAVIS, Ph. D., D. D., '90,	Alfred.
	IRA B. CRANDALL,	Alfred.
	CHARLES STILLMAN,	Alfred.
	WILL R. CLARKE,	New York City.

OFFICERS OF THE BOARD

ALBERT B. COTTRELL, President,	Alfred.
ELWOOD E. HAMILTON, Vice President,	Alfred.
WILLIAM H. CRANDALL, Treasurer,	Alfred.
CHARLES STILLMAN, Secretary,	Alfred.

STANDING COMMITTEES OF THE BOARD

Executive

ALBERT B. COTTRELL, Chairman.

CHARLES STILLMAN, Secretary.

LESTER C. RANDOLPH,	WILLIAM C. BURDICK,
ORVILLE M. ROGERS,	IRA B. CRANDALL,
BOOTHE COLWELL DAVIS,	AMOS A. SHAW,
VERNON A. BAGGS,	ELWOOD E. HAMILTON,
WILLIAM H. CRANDALL.	

Teaching Force

BOOTHE COLWELL DAVIS, DANIEL LEWIS, ORVILLE M. ROGERS.

Buildings and Grounds

CHAS. CLARENCE CHIPMAN,	BOOTHE COLWELL DAVIS,
ALBERT B. COTTRELL,	Mrs. GEORGE H. BABCOCK.

Supplies and Janitors

E. E. HAMILTON, V. A. BAGGS, CHARLES STILLMAN.

Printing and Advertising

W. H. CRANDALL, BOOTHE COLWELL DAVIS, CHARLES STILLMAN.

Auditing

HERBERT G. WHIPPLE.

BOARD OF MANAGERS OF THE NEW YORK STATE SCHOOL OF CLAY-WORKING AND CERAMICS

BOOTHE COLWELL DAVIS,	JOHN J. MERRILL,
WILLIAM H. CRANDALL,	WILL R. CLARKE,
ELWOOD E. HAMILTON.	

LADIES' AUXILIARY COMMITTEE

Mrs. WILLIAM C. BURDICK,	Mrs. MAXSON J. GREEN,
Mrs. EDWIN S. BLISS,	Mrs. SILAS C. BURDICK,
Mrs. VERNON A. BAGGS,	Mrs. ALBERT B. COTTRELL,
Mrs. BOOTHE C. DAVIS,	Mrs. CHARLES STILLMAN.

LIBRARY DIRECTORS

BOOTHE COLWELL DAVIS, President (<i>ex officio</i>).	
EDWARD M. TOMLINSON, Librarian (<i>ex officio</i>).	
CORLISS F. RANDOLPH, representing Trustees.	
ALPHEUS B. KENYON,	" Faculty.
HERBERT G. WHIPPLE,	Alumni.
VERNON W. HOLMES,	Alleghanians.
JOHN M. GILBERT,	Orophilians.
CHARLOTTE E. GROVES,	Alfriedians.
MARY A. BURDICK,	Athenians.

COLLEGE FACULTY

1901—1902.

BOOTHE Colwell DAVIS, Ph. D., D. D., *President*, Charles Potter Professor of History and Political Science.

ABIGAIL A. ALLEN, A. M., Emeritus Professor of Archaeology.

IDA F. KENYON, A. M., Emeritus Professor of Modern Languages.

EDWARD M. TOMLINSON, A. M., William B. Maxson Professor of the Greek Language and Literature.

ALPHEUS B. KENYON, S. M., Rhode Island Professor of Mathematics and George B. Rogers Professor of Industrial Mechanics.

WILLIAM C. WHITFORD, A. M., Professor of Biblical Languages and Literature.

ALBERT R. CRANDALL, Ph. D., Professor of Natural History and Biology.

OTHO P. FAIRFIELD, A. M., William C. Kenyon Professor of the Latin Language and Literature and Professor of English.

EDWARD S. BABCOCK, S. M., Babcock Professor of Physics and Professor of Chemistry.

CATHERINE FOXCROFT CROCKER, Instructor in German and French.

SOPHIE S. REYNOLDS, M. L., Instructor in Elocution.

W[^]ALDO A. TITSWORTH, A. B., Instructor in Philosophy.

ETHEL A. MIDDAGH, Director of Music.

WILLIAM W. HALL, Instructor in Physical Training.

GEORGE A. MAIN, Assistant in Industrial Mechanics.

LINTON B. CRANDALL, Assistant in Industrial Mechanics.

PAUL E. TITSWORTH, Assistant in Modern Languages.

ACADEMY FACULTY

Rev. EARL P. SAUNDERS, A. M., Principal.

Miss DORA KENYON, Ph. B.

Miss LILLIAN O. SPRAGUE.

Mr. WALDO A. TITSWORTH, A. B.

Miss SOPHIE S. REYNOLDS, M. L.

Mr. ALVA L. DAVIS.

Mr. GILBERT A. FARWELL.

Mr. SEYMOUR B. EVERTS.

PRESIDENT'S ANNUAL REPORT

To the Board of Trustees of Alfred University:

The President has the honor to submit his sixth annual report, viz., for the year 1900-1901, beginning June 19, 1900, and ending June 25, 1901.

First, We must acknowledge with gratitude the Divine blessing in the preservation of the life and health of the officers and students of the University.

In the Board of Trustees and in the Faculty, no death or serious illness has occurred. Among the students, one death has occurred, that of Mr. Vernon W. Holmes of the Senior class, who suicided May 8, 1901.

REGISTRATION

The University has enjoyed an increased attendance, both in the College and in the Academy.

The year has been in all respects I think the most successful since my official connection with the University. The registration of the College is 101 students. The registration of the Academy is 156 students. Of this number 17 are duplicates, making a total registration for the year, of 240 individuals; an increase over last year of $33 \frac{1}{3}$ per cent.

The Freshman class numbers 32 members, the largest ever registered in the history of the college.

THE FACULTY

The following changes have occurred in the faculty since the last annual report.

Miss Gertrude B. Harris, B. L., Professor of German and French, was granted a leave of absence for study abroad, and Miss Celestia M. Pember, Ph. B., a graduate of Syracuse University, has

been employed temporarily as Instructor in the department. Her work has been of a high order.

Early in the year Dr. A. K. Rogers, Instructor in Philosophy and Education, was elected to the Professorship of Philosophy in Butler University and resigned his position at Alfred to accept the appointment at Butler. Mr. A. D. Sorensen, A. M., a graduate student of Chicago University, was appointed his successor to the Instructorship in Philosophy and Education. His work in this department has been successful.

In April Professor Frank G. Bates, Ph. D., Charles Potter Professor of History and Political Science, resigned his Professorship to accept the position of State Librarian of Rhode Island.

Mr. Sorensen took charge of Professor Bates' classes for the remainder of the year.

The several departments have been conducted with uniform excellence, and the work of the several Professors and Instructors merits the approval and gratitude of the Board of Trustees.

The President has been absent much of the time during the year, in the interest of the University.

A large amount of work has been done in connection with the teachers' institutes of New York State. Fifteen institutes have been addressed. This work has been done largely at the request of the State Supervisor of Institutes, and the several Institute conductors. I think it is safe to say that your President has done more work among the teachers of the state, and in the interest of Public Instruction, than any other College President in the state.

Much time has been consumed in superintending the construction of the building for the New York State School of Clay-Working and Ceramics, necessitating a number of trips to Albany and elsewhere to interview the state architect and other officials.

One month was given to visiting the Associations and presenting the interests of education in these several meetings.

The President has been absent from the University, in all, about 118 days during the year. He has traveled about 10,000 miles and delivered about 75 sermons and addresses, at a cost of a little over \$400 for traveling expenses.

THE NEW YORK STATE SCHOOL OF CLAY-WORKING AND CERAMICS

During the year the building for the New York State School of Clay-Working and Ceramics, which was begun one year ago,

has been completed at a cost of over \$11,000. It has been thoroughly equipped with clay-working machinery and is now occupied by the instructors of the school.

Five students registered last September for the regular courses in Ceramics, and there have been beside these about a dozen special students in the school.

The new lines of technical and practical instruction offered in this school are attracting universal interest throughout the state, and indeed in many other states.

About eighty samples of clay and shale from different parts of New York state, and some from other states, have been sent to the school for examination and expert opinion as to their value for manufacturing purposes.

There is now a bright prospect for a Summer School in Ceramic Art under the management of Professor Binns, which will attract to Alfred many distinguished artists from all parts of the country.

The first Annual Report of the New York State School of Clay-Working and Ceramics, made by the Director to the President, and by him submitted to the Governor, is appended to this report.

THE ATHLETIC FIELD

Through the efforts of Mr. E. E. Hamilton of this Board a fund of \$450 has been raised for the purchase of a new athletic field. A desirable lot for this field was purchased of Mr. Frank Sisson of Alfred and deeded to the University. At an expense of about \$150, the most of which was raised by the Athletic Association, it has been graded and put in good condition for athletic purposes.

It furnishes excellent accommodations for track athletics, as well as base ball and foot ball, and is sufficiently near to the University to render it very convenient for these purposes.

THE THEOLOGICAL SEMINARY

The Seventh-day Baptist Education Society, at its annual meeting in August, 1900, took action looking toward increasing the efficiency of the Alfred Theological Seminary by increasing its teaching force. The society adopted a plan for raising the necessary funds, and urged the appointment of two additional professors. The Rev. W. C. Daland, D. D., was elected to the Professorship of Theology, and the Rev. J. L. Gamble, Ph. D., to the Professorship of Church History and Homiletics.

Dr. Daland declined to accept the appointment and the professorship therefore still remains vacant.

FINANCIAL POLICY

Some weeks since, the attention of the members of this Board was called, by a letter from the President, to the question of finance, and the necessity for such an economy in the management for the future as will insure a freedom from further deficit.

The indebtedness has increased annually for the past six years at an average rate of about \$3,000 per year. It should not be forgotten however, that while this is true, we have in the same time added to the value of our College equipment, in new buildings, betterments, improvements, and endowments, at an average rate of about \$10,000 per year. We therefore have added to the value of our College plant within the six years \$60,000, but this value is offset by an increased indebtedness of about \$20,000.

The efficiency of the institution with its greatly enlarged and improved equipment, and its greatly increased attendance must also be remembered. Still further it must not be overlooked, that this increase in efficiency and patronage are due to the increased equipment, and could not have been secured without this enlarged expenditure.

That we should have been able in six years, besides meeting our running expenses, to add sixty thousand dollars to the value of the equipment, (forty thousand dollars of which has been contributed) and incur only twenty thousand dollars of indebtedness in so doing, is certainly a matter for congratulation, as well as the fact that our attendance has more than doubled in that time.

But I believe the College has now gathered sufficient momentum and secured sufficient efficiency to limit further improvements to funds actually in hand for such improvement. It therefore seems to me to be a wise policy for the Trustees to limit their expenditures for the coming year to the actual income. The method by which this can be done without weakening the teaching force will be indicated by the report of the committee on retrenchment, and I respectfully urge that the Trustees adopt this policy.

The Treasurer's Report will indicate the commendable growth of the One Hundred Thousand Dollar Centennial Fund, and the encouraging number of One Thousand Dollar Scholarships that have been founded during the year.

I consider these two methods of increasing our endowments, as they have been developed and introduced by our Treasurer, and pushed forward by his untiring energy and tact, to be the most promising channel through which the masses of the people can be enlisted in the financial support of the College.

The Treasurer has received \$500 from the estate of the late Julia M. Powers of New London, Conn., which is to be applied toward the endowment of the William A. Rogers Professorship of Astronomy.

The Treasurer has also received notice that \$663 has been received by the Education Society, from the estate of the late Phineas C. Burdick of DeRuyter, N. Y., the same to be applied toward the permanent fund for the support of Theological education.

These and many other things indicate the growing interest which the people feel in the work of education, and in the growth and prosperity of Alfred University.

The annual reports of the Registrar, the Principal of the Academy, the Librarian, and the Director of the New York State School of Clay-Working and Ceramics, are herewith presented as an addenda to this report.

With profound gratitude for the confidence and support of the Board of Trustees, and for the prosperity which the University has enjoyed during the year, together with the bright prospects for the future, this report is most respectfully submitted.

BOOTHE COLWELL DAVIS, President.

REGISTRAR'S REPORT

Alfred, N. Y., June 25, 1901.

To the President of Alfred University :

As Registrar, I hereby submit the following brief report concerning the recorded work of the College and of the Theological Department for the school year 1900-1901.

As Principal Saunders is this year to report directly to you, I omit from this report the usual statistics in reference to the Academy.

REGISTRY OF STUDENTS.

1st Semester:—In the College,	(a) In residence	93
	(b) Non-resident	2— 95
In the Theological Department		1
Total		96

2d Semester:—In the College,	(a) In residence	88
	(b) Non-resident	2— 90
In the Theological Department		1

Total.

Total different names registered during the school year:

In the College,	(a) In residence	96
	(b) Non-resident	4—100
In the Theological Department		1
Total		101

The 100 registered in College were classified as follows:

Graduate Students	4	(3 being non-resident)
Seniors	9	
Juniors	6	
Sophomores	26	
Freshmen	32	
Special Students	23	

Total.

The following table indicates the number of classes in each department of the College, the number of recitations or lectures per week, and the number of students instructed during each semester:

DEPARTMENT	FIRST SEMESTER			SECOND SEMESTER		
	CLASS-ES	HOURS	STU-DENTS	CLASS-ES	HOURS	STU-DENTS
Philosophy	4	7	68	5	9	71
Greek	4	13	15	4	13	14
Latin	3	8	26	3	8	20
Modern Languages	7	22	116	8	3	108
English	4	8	64	3	7	58
Mathematics and Graphics	5	14	91	7	17	85
Physics and Chemistry	7	17	53	7	17	53
Natural History	4	14	46	3	11	36
History and Political Science	4	12	51	5	14	58
Physical Culture and Elocution		17	60		17	60
Machine Shop Practice		4	11		4	6
Carpenter Shop Practice					4	4

Four candidates entered the Competitive Scholarship examination held June 6th; two from Andover, one from Fillmore, and one from Hammondsport. Three were successful.

This year for the first time in the history of the College, a system of awarding "Honors" to students has been inaugurated.

Honors were awarded to Seniors as follows:

Valedictory Oration to Miss Eugenia L. Marvin for the highest average standing for the entire college course.

Salutatory Oration to Mr. Vernon W. Holmes who stood next in rank, and

Third Honor Oration to Miss Muriel F. Rogers who stood third in rank.

The Freshmen and Sophomores, whose average standing for the year has been 90 per cent or more, and who have no entrance conditions, and who are therefore entitled by the regulations adopted by the Faculty to the award of "Honors" at this Commencement, are the following:

FRESHMEN

Caroline Bell,	Susie M. Langworthy,	Susie C. Lewis,
Ruth H. Mason,	G. Roy Brainard,	Otis B. Brainard,
Seymour B. Everts,	Junius F. Krehbiel,	Frank Ostrander.

SOPHOMORES

Maude C. Babcock,	Flora J. Bell,	H. Elouise Bell,
Susie C. Saunders,	Norine H. Sullivan,	Robert S. Bell,
Gilbert A. Farwell,	Henry N. Jordan,	Joseph E. Myers.

The work of the year as shown by the average percentages earned by the students in the various classes shows very gratifying results. There have been comparatively few failures to complete the work attempted, and a majority of the students have marks showing thorough and conscientious work.

The following, having completed the prescribed courses of study, have been recommended by the Faculty for the degrees indicated after each name:

Albert Babcock Crandall,	Bachelor of Philosophy
Ora Lorena Dennis,	Bachelor of Philosophy
Adalyn June Ellis,	Bachelor of Philosophy
George Manning Ellis,	Bachelor of Science
Louise Keziah Gamble,	Bachelor of Philosophy
Eugenia Lucile Marvin,	Bachelor of Philosophy
Muriel Fanny Rogers,	Bachelor of Philosophy
Sydney Ross Titsworth,	Bachelor of Science
Jay William Crofoot,	Master of Arts
Judson George Rosebush,	Master of Arts

Respectfully submitted,

A. B. KENYON, Registrar.

EXPENSES FOR TEN YEARS

Year	Repairs	Furniture	Janitors	Fuel	Printing	Presid't	Field Secretary
92	118 09	65 37	414 43	248 99	325 26		
93	644 71	213 91	424 22	526 15	245 57		
94	579 56	340 01	354 18	830 94	251 85		
95	727 88	215 50	254 14	586 63	135 43	43 25	5' ° °
96	794 40	21 66	206 10	851 42	535 45	286 70	
97	1,519 22	690 15	302 36	868 18	838 72	83 25	280 00
98	593 50	523 91	901 71	790 14	625 34	301 33	549 ° °
99	679 91	701 45	733 95	883 63	417 64	68 50	42 85
00	734 65	111 14	872 29	1,592 63	505 47	290 21	632 18
01	366 04	503 84	783 29	1,005 58	732 84	417 84	231 69
<hr/>							
	6,757 96	2,883 10	5,246 67	7,184 29	4,613 17	1,491 08	1,786 72

REPORT OF THE LIBRARIAN

For the year ending June 27, 1901.

To the President and Trustees of the University:

The following report concerning the use and growth of the library during the past year is respectfully submitted:

The number of persons who make regular use of the books in the library is large, although this number cannot be reported in definite figures as all persons have free access to the shelves.

There have been drawn from the library during the year 5,462 volumes. Books have been drawn by 280 individuals.

There have been added to the library 966 volumes. Of these, 451 volumes were given by Hon. Geo. H. Utter, of Westerly, R. I. in accordance with the wishes of his father, the late Rev. Geo. B. Utter.

The entire number of volumes donated is 700. 266 volumes were bought. 486 pamphlets have been added.

The whole number of volumes now in the library is 13,886.

REVENUE AND EXPENDITURE ACCOUNTS

From June 1, 1900, to June 1, 1901.

REVENUE.

Balance on hand June 1, 1900:

Account University Fund	\$252	01	
Account Alfredian Lyceum	2	70	
Account Alleghanian Lyceum, overdraft 79c			
Account Athenaeum Lyceum	2	86	
Account Orophilian Lyceum	59—		\$257 37

Received during the year:

Books sold	11	45	
Chair of History and Civics	200	00	
State of New York	100	00	
Gift of Hon. John N. Davidson	25	00	
Sabbath School Board of S. D. B. Gen. Conference	50	00	
Alfredian Lyceum	14	60	
Alleghanian Lyceum	26	70	
Athenaeum Lyceum	9	00	
Orophilian Lyceum	29	60—	\$466 35

\$723 72

EXPENDITURES.

Books for Alfred University.....	459 04	
Books for Alfredian Lyceum....	14 85	
Books for Alleghanian Lyceum..	19 44	
Books for Athenaeon Lyceum ..	5 10	
Books for Orophilian Lyceum..	15 20—	\$513 63
Bookshelves	7 55	
Expressage and Freight	25 49	
Library Supplies	14 95—	47 99
Balance on hand June 1, 1901:		
Account University Fund.....	13 43	
Account Alfredian Lyceum....	2 45	
Account Alleghanian Lyceum..	6 47	
Account Athenaeon Lyceum....	6 76	
Account Orophilian Lyceum..	14 99—	162 10
		\$723 72

Contributions have been received from the following individuals and sources:

Finley Acker	Mrs. Celestia Fuller
Thos. W. Balch	Arthur B. Greene
Dr. Oscar M. Barber	Charles H. Greene
Prof. F. G. Bates	Frank L. Greene
Mrs. Lewis Berry	Mrs. Maxson J. Green
Dr. E. A. Birge	Thos. Green
W. S. Blatchly	F. W. Hamilton
Rev. B. Burdette Brown	Mrs. Ida F. Kenyon
Dr. Alfred S. Burdick	Hon. Erastus C. Knight
Dr. H. P. Burdick	Ethan Lanphear
Mrs. Mary J. Burdick	N. Mortimer Lanphear
Mrs. P. A. Burdick	Chas. Latham
Capt. R. E. Burdick	Rev. A. H. Lewis, D. D
Rev. Stephen Burdick	Dr. Daniel Lewis
Mrs. D. B. Carpenter	Edwin H. Lewis, Ph. D
Judge John B. Cassody	G. H. Lyon
Mrs. Ira Delos Clark	Arthur Mees
William Bullock Clark	John P. Morton & Co.
L. D. Collins	J. S. Ogilvie
William C. Conant	Hon. J. S. Phillips
Mrs. Mary E. Congdon	Dr. W. W. Potter
Miss Hannah Crandall	G. P. Putnam's Sons
Rev. W. C. Daland	Dr. A. K. Rogers
Hon. John N. Davidson	Mrs. W. A. Rogers
President B. C. Davis	Julius F. Sachse, Esq.
Mrs. T. M. Davis	Mrs. Laura Saunders
Hon. Chauncey Depew	Hon. Chas. R. Skinner
Mrs. E. E. Ellsworth	Hon. John S. Smock
Hon. Weston Flint	A. D. Sorensen
Benjamin B. Foster	Miss A. E. Stillman

Chas. Stillman, Esq.	Syracuse University
Hon. Geo. H. Utter	U. S. Government
Alfred Williams	New York State
Mrs. T. R. Williams	China Inland Mission
Prof. Wardner Williams	Peace Association of Friends
N. H. Winchell	Philippine Information Society
Henry Wood	The Macmillan Co.
Mrs. Mary Woolworth	Publishers of
American Sabbath Tract Society	Alfred Sun
Columbia University	Clay Record
Cornell University	Education
Harvard University	Normal Institute
Johns Hopkins University	School
Otterbein University	Sound Currency
St. Johns College	

Valuable additions have been made during the year to the periodicals in the reading room, and apparatus has been provided for the more convenient use and better preservation of periodicals.

In behalf of the Library Directors,

EDWARD M. TOMLINSON, Librarian.

ACADEMY REPORT

TO THE PRESIDENT:

The Academy has enjoyed a prosperous year. The attendance has been very good, 156 students having been registered, an increase of more than 30 per cent over the registration of last year.

The graduating class this year numbers nine; and the prospect is good for a much larger class next year, for there is a marked improvement along the line of systematic pursuance of regular prescribed courses of study.

Seventeen members have been registered in the Teachers' Training Class, and the work done has been of a high order. It is now too early to tell how many of the members will be successful in getting certificates, but we expect that a good percentage have passed. We have the appointment to instruct a class next year, which, in view of the fact that there has been a large reduction in the number of classes in the State, speaks well for the work we have been doing.

The Principal has, for a long time, been trying to bring about an arrangement whereby the Academy could become a free high school for resident pupils of school age, and he asks that the mat-

ter be laid before the Trustees for their approval, so that it may be presented to the district electors at their annual meeting in August.

Respectfully submitted.

EARL P. SAUNDERS, Principal.

STATE SCHOOL REPORT

TO THE PRESIDENT OF THE UNIVERSITY,

Sir:- I have the honor to submit a report of the work done in connection with the New York State School of Clay-Working and Ceramics, since the action of the legislature which founded it.

Chapter 383 of the laws of 1900, established the school, appropriating \$15,000 for a building and equipment, and \$5,000 for maintenance for one year.

The wisdom of this action has been abundantly verified by the remarkable interest which has been shown by the public in the establishment of the school.

The movement for the scientific education of clay workers is rapidly assuming national proportions. The lead was taken by Ohio in the year 1895 when the legislature founded a department of clay working in the Ohio State University. New York was the second in the field, establishing her State School of Ceramics in 1900. Since the passing of the enactment by New York, Iowa has taken steps for the formation of a Clay-Working school at Ames College and now New Jersey is planning a Ceramic department at Rutgers College. These facts illustrate the great interest which is being awakened in the development of the ceramic industries. The National Brick Manufacturers' Association and the American Ceramic Society are alive to the importance of the work, the former organization maintaining a scholarship at the Ohio School.

In New York, not only have Clay-Working industries all over the State shown a deep interest in the school, but many real estate owners have begun investigations, through its aid, to ascertain the availability of their own clay and shale deposits for economic purposes. But most striking of all is the large correspondence which has sprung up with young men in different parts of the state, who are looking toward the school with the hope of securing a technical training in this line of education, which will enable them to develop the enormous clay resources of the state and promote its industries

as well as to place themselves in positions both useful and remunerative.

The Trustees of Alfred University, to whom was entrusted the administration of the New York State School of Clay-Working and Ceramics, appointed, in May, 1900, a Board of Managers for the State School, consisting of five members, and in June this Board appointed me Director of the New York State School of Clay-Working and Ceramics and Professor of Ceramic Technology.

I entered upon my duties in organizing the School, and carrying on the experimental work of the school, July 1st, 1900.

A suitable building for the purpose of the school occupied my attention for some time. It was necessary to provide great stability in the walls to stand the vibration consequent upon running machinery.

Large laboratories and recitation rooms were desirable besides the offices of administration. It seemed important to give considerable attention to the artistic side of clay-working and an art department needed liberal accommodation. Several interviews with the State Architect resulted in planning a building which, notwithstanding the modest amount of the appropriation, will be worthy of its object.

The building is 75 feet by 45 feet in size and is two stories and a half high above the basement.

The corner stone of the building was formally laid on June 20th, 1900, by Senator Humphrey. The occasion was an important one. The State was represented by the Senator and Assemblyman Litchard and Mr. John J. Merrill, chief of the bureau of corporation taxes. The University was represented by yourself with the other members of the Faculty and the Board of Trustees. A large number of the Alumni and patrons of the University and citizens of the surrounding country were present.

The building, now rapidly approaching completion, is built of Alfred brick with stone trimmings and roofed with Alfred tile. It is a substantial and artistically constructed building.

In the basement are placed the engines and heavy machinery. The principal floor contains the offices of administration, a private laboratory, rooms for recitations and technical work and a Ceramic Museum. The second floor is devoted to the Art department and contains a modeling room with lathe and jigger, a room for applied

design, a private room for the instructor, and a large studio for general drawing purposes.

Outside the building is a chimney stack 40 feet in height which is surrounded by a kiln shed. The battery of kilns consisting of a general purpose kiln of about 35 feet cubic capacity, a high temperature kiln about half the size, a muffle kiln for firing decorated wares and small furnaces for experimental work.

The necessary equipment of the laboratory was carefully considered and machinery was ordered for making brick, tile, hollow blocks, roofing tile, etc., and for pottery manufacture.

The machinery for the production of brick, tile, drain tile and hollow blocks consists of five foot dry pan for crushing and disintegrating, a horizontal open pug-mill for blending the clay or shale with water, a brick machine to receive the moist clay and express it in a shaped column, a cutting table whereby the column is separated into the proper sized brick or tile, together with a screw press operated by hand for tile making or repressing brick.

The potters' machinery consists of a special plant of three machines for the preparation of white clays, a vertical pug-mill for compressing the prepared clay, a potters' wheel, a jigger and a turning lathe for shaping wares, a pair of grinding cylinders for the preparation of glazes, and a set of small blungers and grinders for small mixings in an experimental way.

The motive power for the heavy machinery is a 36 h. p. Otto gas engine, and a small Rumsey gas engine of 2 h. p. is provided for the small machines in order to save wear on the main line shaft and pulleys.

All this machinery was ordered early in the summer and much of it has been already delivered.

The preparation and issue of an announcement or circular for the school occupied my attention for sometime during the summer.

A booklet of 16 pages has been printed in which particulars are given of the equipment of the school, the courses offered and the requirements for entrance. The full course of instruction extends over four years and is equivalent to a College course in Science.

On completion of the prescribed curriculum, students will receive the degree of Bachelor of Science in Ceramics. The entrance requirements are the same as those demanded for entrance to a regular scientific course. Shorter courses of one, two or three years are offered to those who may be unable to enter the full

course, and the work will be arranged to meet the needs of any student. The only requirements for entrance to the short courses is an ability to read well and to write good English, with a mastery of the simpler problems of arithmetic.

Certificates are granted to students who take the shorter courses, stating the work which each has accomplished.

With the first class entering even before the completion of the building, five students have registered; three for the full course, who are taking the first year of the course in its regular order. Two students have entered for special work and are also attending recitations in the allied sciences. All the students are residents of the state except one, who comes from New Jersey.

Upon my recommendation the Board of Managers appointed Miss Lillie W. Tourtellotte, Instructor in Art and Graphics. She is a graduate of Pratt Institute and is well qualified for the post.

Subjects allied to technology and art in Clay-Working and Ceramics are taught in their regular departments in the University, thus securing both efficiency and economy. The libraries, laboratories and museums of the University are also accessible to all students of the State School.

Calls have been received from several manufacturing plants which needed advice. I have visited three manufactories in Syracuse and vicinity and was able to give assistance in the solution of technical problems.

Clays have been received for examination from several parts of the state, besides samples from New Jersey, Tennessee and Missouri. The work upon New York clays is done without remuneration. For other clays a fair price is charged.

In the development of the resources of the state, I have been in communication with the Directorate of various railroads, examining the clays and shales along the lines of their roads.

Samples of these deposits are being sent to the school for analysis and experimental manufacture.

I am more and more impressed with the importance of this work in which the state has undertaken to take part. The demands for clay products are increasing daily, and New York State has hitherto been dependent upon other states and foreign countries for a supply which it must have and which is daily growing in magnitude and in the imperative nature of its demand.

The liberality of the state in providing and maintaining such a school is not a stronger evidence of its generous support of education, than it is of its far-sighted economic and industrial wisdom.

The technical education of its own young men for the practical development of the enormous clay resources in which New York is so abundantly rich will eventually enable her to supply her own demands and furnish to the world a large share of these important commodities.

Since entering upon my duties as Director of the New York State School of Clay-Working and Ceramics, I have had the honor to be elected President of the American Ceramic Society.

The following is a statement of the expenditures of the state thus far in the equipment and maintenance of the school, as made by the Treasurer, upon vouchers approved by the State Comptroller:

EXPENDITURE OF BUILDING AND EQUIPMENT FUND

Chapter 383, Laws of 1900

July 1, 1900, to February 15, 1901

Toward Building and Equipment \$6,846 64

EXPENDITURE OF MAINTENANCE FUND

Chapter 383, Laws of 1900

July 1, 1900, to February 15, 1901

Printing and Advertising \$ 222 17
Salaries: Administration and Instruction 2,146 69
Departmental Expenses 236 21
Contingent Expenses 272 28

\$2,877 35

As per itemized vouchers approved by the Comptroller,

W. H. CRANDALL, Treasurer and Accountant.

The text of the announcement is appended to this report.
Printed copies with illustrations are also handed you herewith.

Very Respectfully Yours,

CHAS. F. BINNS, Director.

TREASURER'S REPORT

June 1, 1900, to June 1, 1901

INCOME

REVENUE

BROUGHT FORWARD FROM ANNUAL REPORT, **dated**
June 1, 1900.

Cash on hand.....	\$ 25 70	
Cash in Bank.....	152 69—	\$ 178 39

INCOME FROM ENDOWMENT HELD IN TRUST BY :

Alfred University:

President's Chair.....	52 50	
William C. Kenyon Professorship of the Latin Language and Literature.....	24 00	
George B. Rogers Professorship of Industrial Mechanics.....	441 20	
George B. Rogers Professorship of Industrial Mechanics, Library and Apparatus.....	100 00	
Nathan V. Hull Professorship of Pastoral Theology.....	147 90	
Professorship of Church History and Homiletics.....	4 50	
Plainfield Professorship of Doctrinal Theology..		
Rhode Island Professorship of Mathematics.....	333 47	
Fund to aid Young People Preparing for the Ministry.....	68 00	
Kenyon Memorial Fund.....	7 63	
Indebtedness Notes, (Subscriptions 1887).....	48 96	
One Thousand Dollar Scholarships, viz :		
First Seventh-day Baptist Church of Alfred.....	13 50	
Ladies of Alfred.....	99 00	
Shiloh Seventh-day Baptist Church and Society.....	12 00	
Seventh-day Baptist Church of Plainfield... ..	6 00	
Samuel N. Stillman.....	14 25	
First Seventh-day Baptist Church of New York City.....	6 00	
William Elbridge Witter.....	6 00	
Ladies' Aid Society of the Pawcatuck Sev- enth-day Baptist Church.....	6 00	
Lillian Brown.....	30 00	
Peter Wooden Fund.....	380 20	
David T. Bliss Theological Fund.....	15 00	
Centennial Fund.....	59 "	
General Fund.....	651 78	
Gross Rentals of Real Estate Investments :		
Bliss Real Estate.....	106 42	
O'Connell Real Estate.....	341 50	
Peter Wooden Estate.....	370 50—	3,345 31

<i>Seventh-day Baptist Education Society:</i>			
Plainfield Professorship of Doctrinal Theology.	46	50	
Professorship of Church History and Homiletics			
Professorship of Biblical Languages and Literature	10	00	
Professorship of Natural History	12	00	
General Fund	1,791	46—	1,859 96
<i>Board of Trustees of the Seventh-day Baptist Memorial Fund:</i>			
Plainfield Professorship of Doctrinal Theology..	309	12	
Babcock Professorship of Physics	1,049	90	
William B. Maxson Professorship of the Greek Language and Literature	220	89	
Professorship of Church History and Homiletics	421	65	
Professorship of Pastoral Theology	62		
Alfred University	2	65	
Charles Potter Professorship of History and Political Science.....	1,437	00	
Bi-Centennial Education Fund	121	02	
George H. Babcock Fund	4,387	3*	
E. Lua Babcock Fund.....	1,754	94	
George H. Babcock Fund To Aid Young People Preparing for the Ministry.	280	00—	9,985 15
<i>Alumni Association of Alfred University:</i>			
Kenyon-Allen Endowment Fund.....	500		00
<i>Woman's Executive Board:</i>			
Aid for some Worthy Young Woman			23 67
<i>Seventh-day Baptist Missionary Society:</i>			
Fund To Aid Young People Preparing for the Ministry.			90 00
STATE OF NEW YORK :			
Regents' Academic Fund.....	1	5	00
TUITION FEES:			
Alfred Academy.....	3,073	50	
Alfred Academy, Teachers' Training Class, (State of New York)	455	00	
College of Liberal Arts	2,715	00	
Department of Music	353	00—	6,596 50
TUITION NOTES COLLECTED			34 50
GRADUATION FEES			80 00
SPECIAL EXAMINATION.....	1		00
EXTRA FEES for Materials, Use of Instruments, etc.:			
Art Studio	70	25	
Chemical Laboratory.....	370		00
Drawing Instruments.....	30		55
Gymnasium	19	50	
Machine Shop	78	00	
Microscopy and Botany	125	00	
Reading Room	120	30	
Surveying Instruments.....	8	00	
Wood Shop	14	00	
Zoology	36	00—	871 60
ORATORICAL AND ELOCUTION PRIZE CONTEST:...	1		75
LIBRARY:			
Books Sold.....	11		45

REPORTS, 1900-1901 23

State of New York	100 00	
Gift of Hon. John N. Davidson	25 00	
Seventh-day Baptist Sabbath School Board	50 00	
Alfredian Lyceum	14 60	
Alleghanian Lyceum	26 70	
Athenaeum Lyceum	9 00	
Orophilian Lyceum	29 60	266 35
RENTALS OF CAMPUS BUILDINGS:		
Burdick Hall	291 00	
Gothic	2 00	
Ladies Hall	1,031 81—	1,324 81
SUBSCRIPTIONS COLLECTED:		
Athletic Association	420 13	
Babcock Hall of Physics	424 03	
Chapel Hymn Books	32 60	
Debt Fund, (Subscriptions of 1887)	70 00	
Ladies Hall Porch	5 00	
Reception Room Repairs	75 00—	1,026 76
BORROWED MONEY:		
Bills payable		5,000 00
SUNDRY ITEMS:		
Advertising Pads	22 79	
Examination Paper	18 40	
Fuel	140 83	
Furniture	100 99	
Gas Meter Deposits	132 50	
Stationery	10 80	
Supplies	3 56	429 87
TEMPORARY LOAN REPAID		872 33
		\$32,612 95

EXPENDITURES
FROM COMMON INCOME

For Maintenance

Salaries :		
Teaching Force, et al	11,054 25	
Department of Music, (special)	436 50—	11,490 75
Repairs to Buildings		366 04
Janitors		783 29
Fuel		1,005 58
Supplies to Buildings		307 33
Furniture		503 84
Printing and Advertising		732 84
Annual Catalogue		46 15
Alfred University Monthly		51 25
Diplomas		15 30
Teachers' Training Class		84 4
Natural History		69 52
Care of Reading Room		60 00
President's Traveling Expenses		417 84
Academy Principal's Expenses		13 55
Academy Agent's Expenses	50	94
Field Secretary, Salary and Expenses		167 20
Stenographer		123 33

Insurance	253	15
Sundries	559	51
<i>For Improvements to Campus Buildings</i>		
Babcock Hall of Physics	661	40
Gas Fitting	805	14
Reception Room Repairs	116	56
Ladies Hall Porch	156	71
<i>For Investments</i>		
Bliss Real Estate	58	04
Centennial Fund	221	13
O'Connell Real Estate	173	49
Twentieth Century Plan	125	67
Peter Wooden Estate	508	97
<i>For Sundry Accounts</i>		
Interest on Debt	2,877	71
Scholarships:		
Alfred Academy	702	86
College of Liberal Arts	696	00
Samuel N. Stillman	9	00— 1,407 86
Rebate Tuition	42	25
Card Index System	125	50
Rebate Shop Fees	1	00
School of Clay Working and Ceramics	2,055	30
Advertising Pads	46	12
Gas Meter Deposits	157	50
Museum	30	00
FROM SPECIAL INCOME FOR		
Fund to Aid Young People Preparing for the		
Ministry	432	50
Babcock Professorship of Physics,		
Library and Apparatus, current disbursements. .	419	02
Library and Apparatus, Mrs. George H. Babcock		
(reimbursement)	100	00— 519 02
E. Lua Babcock Fund	321	14
George B. Rogers Professorship of Industrial Me-		
chanics, Mechanical Library and Apparatus.....	83	20
Extra Fees for Material, etc.:		
Chemical Laboratory	431	45
Gymnasium	50	51
Microscopy and Botany	18	75
Reading Room	150	55
Zoology	34	00— 685 27
Library :		
Alfred University	514	63
Alfriedian Lyceum	8	55
Athenaeum Lyceum	5	10
Alleghanian Lyceum	18	14
Orophillian Lyceum	15	20— 5 41 62
Chapel Hymn Books (subscriptions)	32	65
Athletic Association (subscriptions)	40	13

REPORTS, 1900-1901 25

BORROWED MONEY REPAID

Bills Payable 440 00

CASH

Carried forward, June 1, 1901, (common income) :

Cash on Hand	37 58	
Cash in Bank	66 02—	103 60
		\$32,612 95

DEBT STATEMENT COMMON INCOME

DEBIT

Bonds Payable, issue of 1898	\$ 35,000 00	
Bills Payable	9,200 00	
Bills Payable, account of " Babcock Hall of Physics,"	800 00	
Due account of " Debt Fund, subscription notes of		
1887, collected,"	441 63	
Due " Special Income,"	3,737 70	
Accrued Interest on Debt	175 00	
Bills Audited but not paid :		
Fuel	37 65	
Janitors	62 80	
Field Secretary	67 57	
Centennial Fund	2 18	
Meter Deposit	15 00—	195 20
Salaries, Second Quarter, 1900-01	937 50	
Salaries, Third Quarter, 1900-01	1,382 50	
Salaries, Fourth Quarter, 1900-01	2,805 00—	5,125 00
		\$54,674 53

CREDIT

Debt Fund, Subscription Notes of 1887	3,951 55	
" " " " 1887, collected	441 63	
" 1887, of doubtful		
value	1,310 00	
Memorial Hall Notes	236 24	
" " " of doubtful value	107 72	
Babcock Hall of Physics :		
Bills Receivable	100 00	
Two Shares of Stock in Celadon Roof-		
ing Tile Co	100 00	
Subscriptions	1,131 71—	1,331 71
Tuition Notes	229 23	
Due from " Special Income ":		
Charles Potter Professorship of History and		
Political Science	256 10	
Accrued Interest on Endowment held in trust by		
Alfred University	2,031 83	
Cash on Hand	37 58	
Cash in Bank	66 02—	103 60— 8,582 89
Net Debt		\$46,091 64

SPECIAL INCOME BALANCES

CREDIT

George B. Rogers Professorship of Industrial Mechanics, Mechanical Library and Apparatus	\$ 185 86
Fund to Aid Young People Preparing for the Ministry.....	556
Babcock Professorship of Physics.	1,910 3
E. Lua Babcock Fund	534 73
Reception Room Piano.	1 25
Allen-Hall	10 00
Department of Music	67 10
Oratorical Prize Contest	9 75
One Thousand Dollar Scholarships :	
The Samuel N. Stillman	14 25
The William Elbridge Witter.	6 00
The Lillian Brown	30 00
Extra Fees for Material, Etc.:	
Art Studio	7025
Astronomy.	18
Chemical Laboratory.	10 18
Microscopy and Botany.	9 73
Reading Room.	45
Surveying Instruments.	40 60
Wood Shop.	1 00
Zoology and Biology.	4 00
Library :	
Alfred University.	123 83
Alfriedian Lyceum	8 75
Alleghanian Lyceum	7 77
Athenaeon Lyceum	6 76
Orophilian Lyceum....	14 99 - 1 10
	\$3,737 70

DEBIT

Bills Audited, but not paid :

Babcock Professorship of Physics :

Bills Payable, Mrs. George H. Babcock 1,300 00

Department of Music 67 10— 1,367 10

Due "Common Income " :

Charles Potter Professorship of History and Political Science

256 10

ENDOWMENT

PRINCIPAL ACCOUNT

RECEIPTS

Cash on hand, June 1, 1900	1,413 36	
Payments on Notes	5,610 00	
Payments on Bonds and Mortgages	2,225 00	
Estate of Julia M. R. Powers, account William A. Rogers Professorship of Astronomy	500 00	
One Thousand Dollar Scholarships :		
The First Seventh-day Baptist Church of Alfred	66 50	
The Ladies of Alfred	86 75	
The Shiloh Seventh-day Baptist Church and Society	31 00	
The Seventh-day Baptist Church of Plainfield. ..	54 00	
The Samuel N. Stillman	125 00	
The First Seventh-day Baptist Church of New York City	43 60	
The William Elbridge Witter	25 00	
The Ladies' Aid Society of the Pawcatuck Seventh-day Baptist Church	125 00	
The Lillian Brown	1,000 00	
The Class of 1879	10 00	
The Class of 1890	43 00	
The Alleghanian Lyceum	100 00	
The Orophilian Lyceum	100 00	
The Alfredian Lyceum	5 5	
The First Genesee Seventh-day Baptist Church.	100 00	
Peter Wooden Fund	72 25	
Centennial Fund	876 00—	12,658 71

DISBURSEMENTS

Invested in Bonds and Mortgages	10,350 00	
Invested in Real Estate	90 25	
Peter Wooden Fund	1,025 40	
Cash on hand :		
Account Buildings and Grounds	12 00	
The First Seventh-day Baptist Church of Alfred Scholarship	40 94	
The Ladies of Alfred Scholarship	16 75	
The Shiloh Seventh-day Baptist Church and Society Scholarship	12 50	
The Seventh-day Baptist Church of Plainfield Scholarship	98 05	
The Samuel N. Stillman Scholarship	125 00	
The William Elbridge Witter Scholarship	25 00	
The Ladies' Aid Society of the Pawcatuck Seventh-day Baptist Church Scholarship ..	25 00	
The Class of 1879 Scholarship	10 00	
The Class of 1890 Scholarship	43 00	
The Alfredian Lyceum Scholarship	52 25	
Professorship of Church History and Homiletics	250 00	
Nathan V. Hull Professorship of Pastoral Theology	94 20	

Centennial Fund	79 00	
General Fund	402 44	
		\$1,286 13
Less overdraft :		
Account Bliss Real Estate	90 25	
Account Wooden Estate	2 82—	93 07
		\$1,193 06— 12,658 71

ADDITIONS TO THE ENDOWMENT

JUNE 1, 1900, TO JUNE 1, 1901

One Thousand Dollar Scholarships :		
The First Seventh-day Baptist Church of Alfred	66 50	
The Ladies of Alfred	86 75	
The Shiloh Seventh-day Baptist Church and Society	3 ¹ 00	
The Seventh-day Baptist Church of Plainfield. . .	54 00	
The Samuel N. Stillman	125 00	
The First Seventh-day Baptist Church of New York City	43 00	
The William Elbridge Witter	25 00	
The Ladies' Aid Society of the Pawcatuck Seventh-day Baptist Church	125 00	
The Lillian Brown	1,000 00	
The Class of 1879	10 00	
The Class of 1890	43 00	
The Alleghanian Lyceum	100 00	
The Orophilian Lyceum	100 00	
The Alfredian Lyceum	5 ¹ 25	
The First Genesee Seventh-day Baptist Church. . .	100 00—	1,96 ¹ 00
Peter Wooden Fund		7 ¹ 25
Centennial Fund		876 00
Estate of Julia M. R. Powers, account William A. Rogers Professorship of Astronomy		500 00
		\$3,410 35

DECREASE OF ENDOWMENT

Peter Wooden Fund :	
Collateral Inheritance Tax, State of New Jersey	950 91
Improvements to Real Estate, etc	53 75
Disbursements in Disposing of Real Estate	20 74— 1,025 40

CONDITION OF THE ENDOWMENT

HELD BY TREASURER, JUNE 1, 1901

President's Chair :	
Bonds and Mortgages	7 ¹ 50
Notes	100 00
Notes of doubtful value	1,500 00— 2,325 00

William C. Kenyon Professorship of the Latin Language and Literature :		
Bonds and Mortgages	305 00	
Notes*	300 00	
Notes of doubtful value	200 00—	805 00
George B. Rogers Professorship of Industrial Mechanics :		
Bonds and Mortgages	13,000 00	
Note of doubtful value	100 00	
Mechanical Library and Apparatus Fund :		
Bonds and Mortgages	2,000 00—	15,100 00
Nathan V. Hull Professorship of Pastoral Theology :		
Bond and Mortgages	3,000 00	
Notes	485 00	
Cash	94 20 —	3,579 00
Professorship of Church History and Homiletics :		
Bonds and Mortgages	200 00	
Note of doubtful value	100 00	
Cash	250 00—	550 00
Plainfield Professorship of Doctrinal Theology :		
Note		100 00
Rhode Island Professorship of Mathematics :		
Bonds and Mortgages		10,000 00
Fund to aid Young People Preparing for the Ministry		
Bonds and Mortgages	1,100 00	
Notes	500 00—	1,600 00
Kenyon Memorial Fund :		
Bonds and Mortgages	200 00	
Notes	18 38 —	218 38
Buildings and Grounds :		
Cash		12 00
One Thousand Dollar Scholarships :		
The First Seventh-day Baptist Church of Alfred :		
Bonds and Mortgages	320 00	
Cash	40 94	360 94
The Ladies of Alfred :		
Bonds and Mortgages	950 00	
Cash	16 75	966 75
The Shiloh Seventh-day Baptist Church and Society :		
Bond and Mortgage	50 00	
Note	200 00	
Cash	12 50	262 50
The Seventh-day Baptist Church of Plainfield :		
Note	100 00	
Cash	98 05	198 05
The Samuel N. Stillman :		
Bonds and Mortgages	300 00	
Cash	125 00	425 00

ALFRED UNIVERSITY

The First Seventh-day Baptist Church of New York City :			
Bonds and Mortgages	200	00	
The William Elbridge Witter :			
Bond and Mortgage	100	00	
Cash	25	00	125 00
The Ladies' Aid Society of the Pawcatuck Seventh-day Baptist Church :			
Bonds and Mortgages	200	00	
Cash	25	00	225 00
The Lillian Brown :			
Bonds and Mortgages	1,000	00	
The Class of 1879 :			
Cash			10 00
The Class of 1890 :			
Cash			43 00
The Alleghanian Lyceum :			
Bond and Mortgage	100	00	
The Orophilian Lyceum :			
Bond and Mortgage	100	00	
The Alfredian Lyceum :			
Cash			52 25
The First Genesee Seventh-day Baptist Church :			
Bond and Mortgage	100	00	
Peter Wooden Fund :			
Bonds and Mortgages	6,300	00	
Notes	1,000	00	
Notes of doubtful value	716	52	
	\$8,016	52	
Less overdraft	2	82—	8,013 70
Centennial Fund :			
Bonds and Mortgages	1,699	00	
Notes	400	00	
Cash	79	00—	2,178 00
William A. Rogers Professorship of Astronomy :			
Bond and Mortgage	500	00	
General Fund :			
Bonds and Mortgages	1,937	00	
Notes	2,559	00	
Notes not interest bearing	20	00	
Notes of doubtful value	5,086	92	
Real Estate, Woolworth, Alfred	1,700	00	
Real Estate, O'Connell, Hornellsville	4,364	98	
Real Estate, Bliss, Alfred	2,090	25	
Real Estate, Contract	950	00	
Cash	402	44	
Less temporary loan, account Bliss Real Estate	90	25—	312 19— 19,019 34

SUMMARY

Bonds and Mortgages	44,3 ⁵ 00	
Notes, interest bearing	5,7 ⁴² 38	
Notes, not interest bearing	20 00	
Notes, of doubtful value	7,703 44	
Real Estate	8,155 ³	
Real Estate Contract	950 00	
Cash	1,193 06—	68,169 11

Respectfully submitted,

WILLIAM H. CRANDALL, Treasurer.

June 1, 1901.

Examined, compared with vouchers, and found correct.

O. M. ROGERS,
A. A. SHAW, } Auditors.

BUDGET 1901-1902

COMMON INCOME

and special income for salaries

FROM ENDOWMENT HELD IN TRUST BY:

Alfred University:

President's Chair	\$ 40 00	
William C. Kenyon Professorship of the Latin Language and Literature	24 00	
George B. Rogers Professorship of Industrial Mechanics	650 00	
Nathan V. Hull Professorship of Pastoral Theology	150 00	
Professorship of Church History and Homiletics	10 00	
Plainfield Professorship of Doctrinal Theology	400 00	
Rhode Island Professorship of Mathematics	500 00	
Kenyon Memorial Fund	10 00	
One Thousand Dollar Scholarships :		
First Seventh-day Baptist Church of Alfred	15 00	
Ladies' of Alfred	50 00	
Shiloh Seventh-day Baptist Church and Society	12 50	
Seventh-day Baptist Church of Plainfield	10 00	
First Seventh-day Baptist Church of New York City	10 00	
Pawcatuck Ladies' Aid Society	10 00	
Alleghanian Lyceum	5 00	
Orophilian Lyceum	5 00	
First Genesee Seventh-day Baptist Church	5 00	
Peter Wooden Fund	350 00	
General Fund	470 00	
Net Rentals of real estate investments :		
Woolworth Real Estate	200 00	
O'Connel Real Estate	175 00	
Bliss Real Estate	48 00	
Debt Fund, Subscription Notes of 1887	50 00—	2,799 50

Seventh-day Baptist Education Society:

Plainfield Professorship of Doctrinal Theology	46 00	
Professorship of Biblical Language and Literature	10 00	
Professorship of Natural History	12 00	
General Fund	1,750 00—	1,818 00

Board of Trustees of Seventh-day Baptist Memorial Fund:

Plainfield Professorship of Doctrinal Theology	300 00
Babcock Professorship of Physics	800 00
William B. Maxson Professorship of the Greek Language and Literature	300 00
Professorship of Church History and Homiletics	420 00
Professorship of Pastoral Theology	1 00
Alfred University	"
Charles Potter Professorship of History and Political Science	800 00
George H. Babcock Fund	3,500 00
Bi-Centennial Education Fund	100 00—6,143 00

Alumni Association:

Kenyon-Allen Endowment Fund	500 00
--	--------

FROM THE OPERATION OF THE UNIVERSITY :

Tuition Fees:

Alfred Academy	3,*** **
Alfred Academy, Teachers' Training Class	500 00
College of Liberal Arts	2,700 00—6,200 00

Rentals of Campus Buildings:

Burdick Hall	275 00
Ladies' Hall	750 00
Boarding Hall	250 00—1,275 00

State of New York:

Regents' Academic Fund	100 00
---	--------

Total Common Income \$18,835 50

ESTIMATED EXPENDITURES

For Maintenance

Salaries, Teachers	9,600 00
Salaries, Administration	800 00—10,400 00
Repairs to Buildings	275 00
Janitors	725 00
Fuel	875 00
Supplies to Buildings	250 00
Furniture	150 00
Printing and Advertising	500 00
Annual Catalogue	300 00
Alfred University Monthly	50 00
Care of Reading Room	60 00
President's Traveling Expenses	300 00
Stenographer	125 00
Insurance	250 00
Sundries	250 00

For Sundry Accounts

Interest on Debt	2,900 00
Scholarships	1,250 00
Field Secretary	250 00
Centennial Fund	100 00
Improvement to Buildings	100 00
Peter Wooden Estate Interest	200 00

\$19,315 50

ACKNOWLEDGMENT OF GIFTS

The Centennial Fund

This fund, the plan for which was first presented to the attention of the friends of the University two years ago, reached the sum of \$1,302 on June 1, 1900. There was added to it during the year ending June 1, 1901, \$876.

One Thousand Dollar Scholarships

(Act of 1894)

During the year 9ix scholarships have been established conditionally and one full paid. \$1,962.10 has been received on principal account, of which \$556.85 was paid on account of Scholarships previously founded, and \$1,405.25 on account of new Scholarships.

MAY, 1895. THE FIRST SEVENTH-DAY BAPTIST CHURCH OF ALFRED SCHOLARSHIP has been increased \$66.50, making the principal \$360 94.

FEBRUARY, 1896. THE LADIES OF ALFRED SCHOLARSHIP has been increased \$86.75, making the principal \$966.75.

MAY, 1896 THE SHILOH SEVENTH-DAY BAPTIST CHURCH AND SOCIETY SCHOLARSHIP has been increased \$31.00, making the principal \$262.50.

MAY, 1896. THE SEVENTH-DAY BAPTIST CHURCH OF PLAINFIELD SCHOLARSHIP has been increased \$54.00, making the principal \$198.05.

JUNE, 1899. * * * SAMUEL N. STILLMAN SCHOLARSHIP has been increased \$125.00, making the principal \$425.00.

OCTOBER, 1899. THE FIRST SEVENTH-DAY BAPTIST CHURCH OF NEW YORK CITY SCHOLARSHIP has been increased \$43.60, making the principal \$200.

NOVEMBER, 1899. THE WILLIAM ELBRIDGE WITTER SCHOLARSHIP has been increased \$25, making the principal \$125.

FEBRUARY, 1900. THE LADIES' AID SOCIETY OF THE PAWCATUCK SEVENTH-DAY BAPTIST CHURCH SCHOLARSHIP has been increased \$125.00, making the principal \$225.00.

JUNE, 1900. THE LILLIAN BROWN SCHOLARSHIP. The following letter explains itself:

HARRISBURG, Pa., June 19, 1900.

PROF. BOOTHE COLWELL DAVIS,

President Alfred University,

Alfred, N. Y.

MR. PRESIDENT : —

With some appreciation of the value of Alfred University, and from a desire to use from our limited accumulations a portion thereof in the surest manner for doing good, there is handed to you herewith a check for \$1,000. to the order of the University Treasurer, in full payment for the establishment of a University scholarship.

The same is given in commemoration of the name and life of purity of our daughter Lillian, born April 16, 1871; died September 28, 1891; and who, for a short time, was a student at Alfred.

This establishment is made in accordance with the University regulations, and to be designated in its records for all time as "The Lillian Brown Scholarship."

Very truly yours,

MR. and MRS. ISAAC B. BROWN.

JUNE, 1900. THE CLASS OF 1879 " making an effort to establish a scholarship, and \$10 has been paid on account from one member of the class.

NOVEMBER, 1900. THE CLASS OF 1890 is making an effort to establish a scholarship, and \$43 has been paid on account.

DECEMBER, 1900. THE ALLEGHANIAN LYCEUM SCHOLARSHIP was established by the lyceum whose name it bears. \$100 has been paid on account.

DECEMBER, 1900. THE OROPHILIAN LYCEUM SCHOLARSHIP was established by the lyceum whose name it bears. \$100 has been paid on account.

MAY, 1901. THE ALFRIEDIAN LYCEUM SCHOLARSHIP was established by the lyceum whose name it bears. \$52.25 has been paid on account.

MAY, 1901. THE FIRST GENESEE SEVENTH-DAY BAPTIST CHURCH SCHOLARSHIP was established by the church whose name it bears. \$100 has been paid on account.

Bequest

MRS. JULIA M. ROGERS *Powers*, a sister of the late Prof. William A. Rogers, died at New London, Conn., April 4, 1899. Her will contained the following clause:

"I give and bequeath to Alfred University of Alfred, New York, the sum of five hundred (\$500) dollars, the net income of which is to be used for the expenses of the professorship of astronomy of said University."

This bequest was paid November 7, 1900, by her husband, Mr. George H. Powers, who was her executor, and was passed to the credit of the WILLIAM A. ROGERS PROFESSORSHIP OF ASTRONOMY.

During the year the SEVENTH-DAY BAPTIST EDUCATION SOCIETY received from J. Reed Burdick, executor of the estate of PHINEAS C BURDICK, formerly of DeRuyter, N. Y., the sum of \$663.40 to be held in trust as endowment, the income to be paid to Alfred University for the support of the Theological Department, upon condition that "no person to whom the income from this bequest shall be paid shall be a member of any secret society."

Gifts to the Library

HON. JOHN N. DAVIDSON, E. M., '54, of Wiscoy N. Y., contributed \$25 to the fund for the purchase of books.

THE SEVENTH-DAY BAPTIST SABBATH SCHOOL BOARD contributed \$50 for the purchase of books.

REV. GEORGE B. UTTER, D. D., of Westerly, R. I., by his will directed his Executor to "deliver to the person or persons having charge of the Library of Alfred University, for the use of said library forever, books from my library to the value of one thousand dollars, including such encyclopaedias as he may think most desirable for the use of said library; and a complete set, so far as they can be found there, of all publications of the Seventh-day Baptist Denomination, issued during my life-time." In compliance with the terms of the will, Hon. George H. Utter, the executor, has this year forwarded a part of these books, (See Librarian's Report.)

Mr. Utter was named as a Trustee in the Act of Incorporation of Alfred University, and continued a member of the Board of Trustees until 1874. He died in 1892.

Gifts to the Museum

PETER H. VELTHUYSEN, Haarlem, Holland. Collection of insects.

CLARENCE W. SPICER, Edelstein, Ill. Bird Skins, 12 species, 15 specimens.

Miss LELA WILSON, Attalla, Ala. Silicified Wood.

CHARLES STILLMAN, Alfred, N. Y. Volume of Plates. Edible and other Fungi.

Miss HANNAH CRANDALL, Westerly, R. I. State Money, Eagle Bank of New Haven, 1822. One dollar bill and three dollar bill.

HON. B. A. PACKARD, Bisbee, Ariz. Copper Ores, Azurites and Malachites.

REV. WILLIAM C DALAND, Leonardsville, N. Y. Stool from Ayan Maim, West Africa, used by the Fanti people.

Miss SUSIE M. BURDICK, Shanghai, China. Book of Chinese Coins, Tail of Angora Goat, Lapis Lazuli, etc., from Thibet.

JOSEPH BOOTH, Cholo, Africa. Skin of an African snake.

During the year the mineral specimens presented by Col. H. B. Maxson, of Reno, Nev., have been placed in new cases, constructed especially for the better display of this valuable collection

A. D. BABCOCK, Alfred, N. Y. Old French Coin, (silver.)

DR. AMOS C. LEWIS, New York. Collection, corals, Echini, etc., Bermuda Islands, 25 species.

SOPHIA J. WRIGHT, Traverse City, Mich. The Dunlap-Wright collection from Eastern Countries, relics and Scripture translations into Oriental Languages. The Dunlap-Wright Botanical Collection, 500 Specimen Cryptogams, 600 species Phaenogams. The Dunlap-Wright coins, Grecian, Turkish, Ancients Corinth and Syracuse, Norwegian, Austria and American, 36 pieces,

Presented through DR. ELLA SWINNEY from her friends in China. Book of Chinese and Japanese coins from 220 B. C. to 1875, 86 pieces.

ATHLETIC FIELD

About four acres of land have been purchased of Frank Sisson for the use of the Athletic Association. The field lies on the flat north of the Celadon Roofing Tile Co's plant, and cost, including a drive way one rod in width extending to North Main street, \$425. A sufficient number of life memberships in the Athletic Association, at \$25 each, were placed to purchase the field, and donations were made to fit it for use. The following is a list of life members and donors:

Orson C. Green	\$25 00	Harold Randolph.....	25
Capt. R. E. Burdick.....	25 00	Charles Beckwith.....	50
Hon. John N. Davidson...	25 00	George Bassett.....	3 00
Sun Publishing Associator	25 00	Lorenzo Barber.....	3 00
Lyle Bennehoff.....	25 00	William I. Langworthy.....	3 00
Will R. Clarke.....	25 00	Lewis S. Beyea.....	2 80
Pres. Boothe C. Davis.....	25 00	Adelbert Potter.....	3 00
Rev. Lester C. Randolph.	25 00	Fred Gleason.....	1 00
Charles T. Harris.....	25 00	Willard A. Barber.....	50
Frank L. Greene.....	25 00	Lynn Davis.....	1 40
Calvin D. Reynolds.....	25 00	Linton Crandall.....	2 37
A. J. Armstrong & Son..	25 00	Frank Langworthy.....	1 25
Vernon A. Baggs.....	25 00	Allen M. Wallace.....	1 25
Elwood E. Hamilton.....	25 00	LaVerne Bassett.....	1 25
William H. Crandall.....	25 00	George Main.....	37
D. Sherman Burdick.....	25 00	B. Sheffield Bassett.....	50
John J. Merrill.....	25 00	Merle Place.....	50
Walter L. Greene.....	62	Bernard McNeil.....	87
Frank Sisson.....	2 25	Daniel C. Babcock.....	25
John F. Langworthy.....	60	Frank Ostrander.....	25
H. Eugene Davis.....	2 37	Junius F. Krehbiel.....	25
Sheldon Babcock.....	1 50	C. LaVerne Elliott.....	25
Truman Crandall.....	1 25	Lewis L. Segur.....	25
J. Fred Whitford.....	75	James Groves.....	25
Henry N. Jordan.....	56	Robert S. Bell.....	25
John Brown.....	56	Harry B. Case.....	25
Harry Langworthy.....	50	Clarence L. Clarke.....	25
Arthur Cottrell.....	1 00	Peter H. Velthuysen.....	25
Sydney Titsworth.....	1 43	Total.....	\$470 13
Q. Deane Langworthy...	43		
William N. Langworthy.	2 00		

ENDOWMENT AND PROPERTY.

THE ENDOWMENT FUND has increased with gratifying rapidity in recent years. The interest-bearing funds now amount to about \$250,000, which, together with all its other property, is held in trust by Alfred University, except as otherwise specified below. The value of the entire property of the University, including endowments, buildings, grounds, library, educational collections, and apparatus, is nearly \$450,000.

THE SEVENTH-DAY BAPTIST EDUCATION SOCIETY, which was organized in 1855 and incorporated under the Laws of the State of New York in 1857, holds in trust for the benefit of the University about \$44,000.

THE GEORGE B. ROGERS PROFESSORSHIP OF INDUSTRIAL MECHANICS was established in 1867. Mrs. Ann M. R. Lyon, of New York City, gave \$10,000 toward its endowment, and the professorship was given the name of her son, who had died while educating himself for a Mechanical Engineer. The trustees of the University raised \$5,000 additional toward the endowment of the professorship. In accordance with the terms of Mrs. Lyon's gift, the income of \$13,000 is used in paying the salary of the incumbent, and the income of \$2,000 in the purchase of books and apparatus, and in securing the general efficiency of the department.

THE BABCOCK PROFESSORSHIP OF PHYSICS was established by George H. Babcock, of Plainfield, New Jersey, in 1881. He endowed it with \$20,000, the income or so much as might be necessary, to be used in paying the salary of the incumbent,—surplus income to be used for the purchase of books and apparatus for the Department of Physics. The principal is held in trust by the Board of Trustees of the Seventh-day Baptist Memorial Fund.

THE WILLIAM B. MAXSON PROFESSORSHIP OF THE GREEK LANGUAGE AND LITERATURE was established in 1881. George H. Babcock, of Plainfield, New Jersey, gave \$10,000 toward the endowment of the professorship. The principal is held in trust by the Board of Trustees of the Seventh-day Baptist Memorial Fund.

THE CHARLES POTTER PROFESSORSHIP OF HISTORY AND POLITICAL SCIENCE was founded in 1888 by Charles Potter, of Plainfield, New Jersey, who endowed it with \$20,000, the income, or so much as might be necessary, to be applied in payment of the salary of the incumbent, the surplus to be expended in the purchase of books for the library. The fund is held in trust for the University by the Board of Trustees of the Seventh-day Baptist Memorial Fund. Mr. Potter died December 2, 1899.

THE RHODE ISLAND PROFESSORSHIP was established and named by the Misses Harriet and Maria L. Pottter, of Potter Hill,

Rhode Island, who bequeathed to the University the sum of \$5,000 each, as a perpetual fund for its maintenance. The income has been assigned by the University to the support of the Chair of Mathematics. Miss Harriet Potter died in 1886. Miss Maria L. Potter died in 1891.

GEORGE H. BABCOCK FUND. E. L. A. BABCOCK FUND. By the provisions of the will of the late George H. Babcock, of Plainfield, New Jersey, \$70,000 were given to the Board of Trustees of the Seventh-day Baptist Memorial Fund, in trust, for the University. The income of \$50,000 was designated to be used in such manner as the University may deem best, and the income of \$20,000, known as the E. L. A. BABCOCK FUND, to be used "in keeping the grounds in good order and repair and for the purpose of inculcating ideas and habits of order and neatness among the students."

Mr. Babcock died December 16, 1893. He had been a member of the Board of Trustees of the University since 1881, and, at the time of his death, was its President.

THE KENYON-ALLEN ENDOWMENT FUND, which the Alumni Association set about raising immediately on its organization in 1886, now amounts to over \$10,000, and is increasing yearly.

PETER WOODEN FUND. Peter Wooden, of North Plainfield New Jersey, bequeathed to the University \$500, and also made it residuary legatee. The amount which will be derived from this source has not yet been ascertained, but it is expected that the University will realize at least \$20,000. Mr. Wooden died January 14, 1895.

SUMMARY

ENDOWMENT HELD BY :	PRODUCTIVE ENDOWMENT.	ENDOWMENT.
Alfred University.....	\$ 57,000 00	\$ 68,169 "
" " Peter Wooden Estate.	19,330	00
" " H. Alice Fisher Real Estate.		3,000 00
Seventh-day Baptist Education Society...	32,916 93	43,961 36
Board of Trustees of the Seventh-day Baptist Memorial Fund.....	147,734 66	147,734 66
Alumni Association of Alfred University..	9,200 00	10,108 59
Total Productive Endowment.....	\$246,851 59	
Total Endowment.		\$292,303 72
PROPERTY USED BY THE UNIVERSITY :		
Grounds.	11,000 00	
Buildings.	80,000 00	
Furniture.	11,000 00	
Apparatus.	22,000 00	
Library.	19,000 00	
Museum.	12,500 00—	155,500 00
TOTAL ENDOWMENT AND PROPERTY		

PETER WOODEN ESTATE

Estimated value of equity in real estate..... \$19,330 00

INCOME AND EXPENDITURES

Received from rentals, June 1, 1900 to June 1, 1901. \$370 50
Paid out for repairs, taxes, collecting rents, etc. 308 97

Balance 61 53
Interest on \$4,000 mortgage. 200 00

Leaving \$138 47
to be paid out of income of Peter Wooden Fund.

PETER WOODEN FUND

By vote of the Board of Trustees at the Annual Meeting in 1896, all moneys received from the Executor of Peter Wooden, deceased, and the proceeds of real estate devised by Peter Wooden to Alfred University, form a permanent endowment under the name of PETER WOODEN FUND.

RECEIPTS

From Executor, previously reported \$2,546 74
From sales of real estate, previously reported 7,550 ..
From sales of real estate, current year, viz:
 Lots 34 and 35 sold to Daniel B. VanOrden (\$200.)
 Payment on VanOrden Contract \$70 00
 Damages on widening Somerset St. 2 25 72 25
Total receipts on Principal Account \$10,168 99

DISBURSEMENTS

Previously reported —\$1,124 48
Error in previous report 5 41
Current year, viz:
 Collateral inheritance tax, New Jersey. \$950 91
 Betterments etc. 53 75
 Sundry disbursements. 20 74—1,025 40—2,155 29

PETER WOODEN FUND \$8,013 70

E. LUA BABCOCK FUND

The routine work of caring for the grounds has been attended to, and the following permanent improvements have been made:

A well six inches in diameter has been drilled on the Campus above the Reservoir to a depth of 182 feet, which is capable of furnishing 1,000 barrels of water per hour, within thirty feet of the top. A pump has been put in to lift the water from the well so that it will run into the reservoir. The pump is worked by an electric motor; the power for motor is generated at Babcock Hall of Physics.

Extensive grading around the east end of Ladies Hall has been done, and a large sewer drain has been laid south of Ladies Hall to take the drainage from the south side of the Campus to the creek.

3,772 square feet of artificial stone walk has been laid along the east side of Ladies Hall, connecting with walk previously laid from Kenyon Memorial Hall to University Place. (Since Commencement 12,536 square feet of artificial stone walk has been laid, a more detailed account of which will be presented in the next Annual Report.)

FINANCIAL STATEMENT

Balance unexpended June 1, 1900		\$995 72
Income, June 1, 1900, to June 1, 1901		1,754 94
Total		2,750 66
Expended, June 1, 1900, to June 1, 1901:		
Labor of divers persons, mostly students	\$727 17	
Drilling well and testing same	296 97	
Well house, pump, motor and installation...	203 05	
Tile drain pipe	200 27	
Artificial stone walk, (Devoe) (3,772 Sq. Ft.)	565 80	
Lawn seats for Campus (12)	65 32	
Plants and flowers	31 00	
Grass seed and fertilizers	5 47	
Tools and snow plow	4 74	
Cement, lime and sand	10 03	
Flag pole	6 27	
Disinfectants	18 00	
Repairing lamps on Campus	5 58	
Sundry items	76 26	2,215 93
Balance unexpended June 1, 1901		\$534 73

COMMITTEE ON JANITORS AND SUPPLIES

The Committee on Janitors and Supplies begs to submit the following report for the year ending May 31st, 1901.

The committee audited during the year 193 bills, aggregating \$3,020 76, which may be classified as follows:

For Janitors	\$ 714 67
" Furniture	199 92
" Furniture, by order of Ex. Com	210 08
" Supplies	299 72
" Fuel	982 45
" Gas fitting	228 72
" Gas fitting, by order of Ex. Com	181 40
" Meter Deposits	137 50
" Repairs Ladies Hall, by order of Ex. Com	66 30
Total	\$3,020 76

A tabulated statement is appended showing in detail the disbursements of the committee for the four years during which the present committee has held continuous office.

We estimate that the following sums will be needed by the committee the ensuing year.

For Janitors	\$ 75 00
" Furniture	150 00
" Supplies to Buildings	250 00
" Fuel	875 00
Total	\$2,000 00

In addition a sufficient appropriation should be made to put in hard wood flooring in at least five rooms in Ladies Hall.

Respectfully submitted,

E. E. HAMILTON, }
V. A. BAGGS, > Com.
C. STILLMAN,)

JANITORS

	1900-01	1899-00	1898-99	1897-98
Appropriated by Budget	\$700 00	\$750 00	\$700 00	\$700 00
Expended				
Ladies Hall :				
Matron and Laundry	249 00	223 67	202 33	250 00
Sundry Items	6 63	149 84	165 16	171 15
Burdick Hall:				
Matron and Laundry	93 00	111 84	108 22	100 00
Sundry Items	6 63	6 85	26 27	80 00
All other buildings	359 41	294 54	257 26	295 81
	<hr/> \$714 67	<hr/> \$786 74	<hr/> 759 24	<hr/> \$896 96

NOTE—In addition to salaries paid in cash the following rooms are assigned for Janitors' accommodations : Suite of rooms on first floor of Burdick Hall, valued at \$75.00; two rooms in Ladies Hall for use of matron, heated, valued at \$50.00; five rooms in the Gothic, heated, valued at \$75.00; bell-room in Chapel, heated, valued at \$40.00. Prior to 1900-01 two rooms in Burdick Hall, which are now paying cash rentals, were also occupied by janitors. It will be observed that since Ladies Hall has been equipped with gas stoves a saving in janitor work of something like \$150.00 annually has been effected.

FURNITURE

	1900-01	1899-00	1898-99	1897-98
Appropriated by Budget	\$200 00	\$150 00	\$200 00	\$250 00
	210 08			
Expended				
Ladies Hall Dining Room	38 60	35 54	13 19	156 87
Ladies Hall Dormitory	231 65	83 09	124 92	298 86
Burdick Hall	118 04	12 35	7 66	135 56
Gothic			5 00	10 95
Allen Steinheim Museum			25 00	
Kenyon Memorial Hall				
Chapel			25 00	6 73
Babcock Hall		15 00		
Recitation Rooms	21 71	28 00		
	<hr/> +\$410 00	<hr/> \$173 98	<hr/> \$200 77	<hr/> \$608 97
Credit				
Broken Dishes, etc.	\$19 14	\$19 62	\$3 50	
Stoves sold	21 00			
*Stoves donated by students in Burdick Hall	60 85			
Sundry				
	<hr/> \$100 99	<hr/> \$19 62	<hr/> \$3 50	
Net	<hr/> \$309 01	<hr/> \$154 36	<hr/> \$197 27	<hr/> \$608 97
tAuthorized by Executive Committee	\$210 08.			
*Donors				
J. F. Krehbiel	Geo. A. Main			
H. Smith	J. F. Whitford & Bro.			
A. M. Wallace	L. L. Segur			
Theo. Davis	C. H. Greene			
	M. A. Place			
	P. Velthuysen			
	F. Ostrander			

SUPPLIES				
	1900-01	1899-00	1898-99	1897-98
Appropriated by Budget	\$300 00	\$200 00	\$125 00	\$200 00
Expenditures:				
Ladies Hall—Dining Dept.	36 92	16 75	19 74 }	96 10
" Dormitory	156 11	28 48	94 70 }	
Burdick Hall	18 03	4 44	16 30	4 39
Recitation Rooms, etc.,	88 66	*75 08	39 34	72 44
Total	\$299 72	\$124 75	\$170 08	\$172 93
Credit:				
Supplies sold	\$ 3 56			
Net.	\$296 16	\$123 75	\$170 08	\$172 93
*Of this item, \$45 32 properly belongs to Babcock Hall construction account.				

FUEL.				
	1900-01	1899-00	1898-99	1897-98
Appropriated by Budget	\$1,000 00	\$ 900 00*	\$1,000 00	\$ 675 00
Expended :				
Ladies Hall	215 10	316 92	277 91	252 65
Burdick Hall	54 55	27 75	56 96	187 50
Chapel	117 45	93 31	178 68	189 65
Gothic	83 55	69 30	82 83	96 22
Allen Steinheim Museum	57 45	60 60	58 63	44 69
Kenyon Memorial Hall			188 29	234 08
Babcock Hall	{ 454 35	449 48	38 29	5 21
Total	\$982 45	\$1,017 36	\$881 29	1,010 30
Fuel sold				
Ladies Hall	\$87 04	\$28 72	\$7 05	?9 39
Burdick Hall	50 89			
Chapel	1 05			
Gothic	1 85			
Total	\$140 83	\$28 72	\$7 05	\$9 39
Net	\$841 65	\$1,005 53	\$74 4	\$1,000 91
* Exclusive of Babcock Hall.				

NOTE.—Natural gas was first used to heat Kenyon Memorial Hall during the school year of 1898-99. The following year it was installed into the Gothic, Chapel, Steinheim, a portion of Ladies Hall, and the Babcock Hall of Physics, Kenyon Memorial Hall being connected with the latter building so that both were heated from the same plant. At beginning of the present year (1900-01), the two dormitories were fully equipped for gas so that all the buildings on the Campus are now heated and lighted with natural gas. The dormitory rooms are each provided with a meter and the students pay for actual amount of gas consumed.

G A S F I T T I N G

	1900-01	1899-00	1898-99
Appropriated by Budget	\$250 00		
Expended			
Ladies Hall	168 07	\$224 24	
Burdick Hall	184 55	25 16	
Gothic	8 00	45 14	*8 32
Chapel	48 48	73 32	
Kenyon Memorial Hall	1 02	1 42	*20 48
Allen Steinheim Museum		29 56	
Babcock Hall of Physics		130 81	
Total	\$410 12	\$530 65	*\$28 80

*Charged to Fuel account. f Authorized by Executive Committee.

NOTE.—Forty-three meters belonging to the Mutual Gas Co., Ltd., were placed in Ladies and Burdick Halls in 1900-'01 upon which a deposit of \$37-50 " " " made in addition to above figures. A deposit of \$5 is in turn required for each room rented.

L A D I E S H A L L

	1900-01	1899-00	1898-99	1897-98
Rentals Received				
Dining Department	\$332 41	\$370 07	\$354 67	\$353 85
Dormitory				
Resident tenants (unfurnished rooms)	127 00	118 00	148 67	168 50
Transient and Summer	66 25	60 25	67 00	65 07
Students	479 15	667 50	672 00	435 50
Gross earnings	\$1,004 81	\$1,215 82	\$1,242 34	\$1,022 92
Maintenance				
Fuel, net	\$128 06	\$288 20	\$270 86	\$243 56
Supplies, Dining Dep't	36 92	16 75	'9 74 }	96 10
Supplies, Dormitory	156 11	28 48	94 70 }	250 00
Matron and Laundry	249 00	223 67	202 33	171 15
Other Janitor labor		149 84	165 16	
Total	\$570 09	\$706 94	\$752 79	\$760 81
Net	\$434 72	\$508 88	\$489 55	\$262 11
Betterments				
Furniture, Dining Dep't	\$38 60	\$35 54	\$13 19	\$156 87
Furniture, Dormitory	231 65	83 09	124 92	298 86
Gas Fitting	168 07	224 24		
Total	\$438 32	\$342 87	\$138 11	\$455 73

NOTE.—Prior to the year 1900-01 rooms have been rented to students heated and lighted. The price charged the present year does not include these items, gas being charged extra for actual amount used.

	BURDICK HALL			
	1900-01	1899-00	1898-99	1897-98
Gross Rentals	\$291 00	\$186 75	\$161 25	\$526 50
Maintenance				
Fuel	3 66	27 75	56 96	187 50
Janitor and laundry	93 00	118 69	134 49	180 00
Supplies	18 03	4 44	16 30	18 67
Total	114 69	150 88	207 75	386 17
Net	\$176 31	\$35 87	*\$6 50	\$140 33
Betterments				
Furniture	\$118 04	\$12 35	\$7 66	\$135 56
Gas fittings	184 55	25 16		
Total	\$302 59	\$37 51	\$7 66	\$135 56

*Loss

NOTE.—During school year of 1897-98, the rent charged for rooms included heat and lights.

GIFTS AND BEQUESTS

SUGGESTIONS

The demands upon institutions of learning are broadening, year by year, and equipment and endowment must be increased to keep pace with the demands. Alfred forms no exception to the rule. With the assistance of her friends, she has been enabled to meet all requirements in the past. Relying upon a continuation of that kindly interest in her work, there is here presented for consideration a variety of channels in which substantial aid in meeting the demands of the future may be directed. Those who wish to perpetuate their usefulness and their memory, and make their deeds live after them, cannot better do so than by giving or bequeathing something to Alfred University in one of the following ways :

INCREASE IN THE GENERAL ENDOWMENT FUND, the income of which shall be at the disposal of the University for its general expenses.

THE CENTENNIAL FUND was established in 1899 with the expectation that it will amount to \$100,000 00, when the University shall celebrate its centennial. Gifts to this fund may be made from \$1.00 to \$100.00.

THE ENDOWMENT OF PROFESSORSHIPS. Twenty-five thousand dollars will fully endow a professor's chair.

THE ENDOWMENT OF SCHOLARSHIPS to pay the term bills of worthy, but needy, students. One thousand dollars will endow a scholarship.

A scholarship may be instituted conditionally upon the payment of one hundred dollars, and kept alive by the payment of not less than twenty-five dollars every two years thereafter, until one thousand dollars have been paid; and the beneficiary will be credited on his tuition charges with the income of the fund. In the case of scholarships founded by Societies, if twenty-five dollars or more be added to the principal annually, the beneficiary will be granted free tuition.

A LIBRARY BUILDING which will cost, say \$25,000.

The gift of books and of money to buy books.

Every gift will be used as the donor may direct. The giver of fifty dollars or more will be asked to allow his name to be used in connection with the gift in the reports of the University.

THE FOLLOWING FORMS OF BEQUESTS ARE RECOMMENDED :

1 I give, devise, and bequeath to **ALFRED UNIVERSITY**, located at Alfred, New York, the sum of _____ dollars, to be safely invested, and called " The _____ General Endowment Fund "; the net income only to be used for the general expenses of the University.

2 I give, devise, and bequeath to **ALFRED UNIVERSITY**, located at Alfred, New York, the sum of Twenty-five thousand dollars, to be safely invested, and called " The _____ Professorship "; the net income only, or so much thereof as may be necessary, to be used to pay the salary of the incumbent of said professorship, the surplus income, if any, to be at the disposal of the University.

3 I give, devise, and bequeath to **ALFRED UNIVERSITY**, located at Alfred, New York, the sum of One thousand dollars, to be safely invested, and called " The _____ Scholarship "; the net income only to be used for the payment of the term bill of some worthy and needy student, the surplus income, if any, to be at the disposal of the University.

4 I give, devise, and bequeath, to **ALFRED UNIVERSITY**, located at Alfred, New York, the sum of _____ dollars to be expended in the purchase of books for the Library.

SCHOLARSHIPS

The fees that students in Alfred University are required to pay are known as tuition fees, incidentals, and extra fees. The following statement shows the total tuition and incidental fees charged, the allowances on account of scholarships, and the cash income from such fees, in each of the last four years (excluding income from the Training Class) viz:

Year		Tuition and Incidental Fees	Scholarships	Cash
1897-98	Academy	\$2,599	\$606	\$1,993
	College	1,651—\$4,250	379—\$985	1,272—\$3,265
1898-99	Academy	2,137	420	1,717
	College	1,821—3,958	439—859	1,382—3,099
1899-00	Academy	1,900	520	1,380
	College	2,009—3,909	408—928	1,601—2,981
1900-01	Academy	3,073	711	2,361
	College	2,715—5,788	696—1,407	2,019—4,380

Three systems of scholarships are in force in the University, as follows:

TEN PER CENT SCHOLARSHIPS. These were established many years ago on the following terms: The University agreed to pay, by allowance upon tuition fees, ten per cent per annum on moneys donated to its funds; but the founders of the scholarships were not to use them to the detriment of the University by selling, renting or leasing them, although they might donate the use of them to any person or persons who depended entirely upon their own exertions to defray their educational expenses. Incidental and extra fees, however, must be paid in cash by the beneficiaries of the scholarships.

ONE THOUSAND DOLLAR SCHOLARSHIPS. A CT OF 1894. These may be established conditionally on the payment of \$100, and they will continue in force so long as payments are made amounting to at least \$25 in two years; but they become permanent when the sum of \$1,000 is fully paid. The owner of a scholarship is entitled to keep one student in attendance at the University whose tuition fees, incidental fees, and extra fees, will be paid out of the income of the principal fund, if the income is sufficient to pay the same, but if not, the remainder of such fees must be paid in cash by the student. Societies endowing scholarships conditionally, and paying at least \$25 a year toward the principal, will be allowed free tuition fees for one student every year; but the student must pay incidental and extra fees in cash.

COMPETITIVE FREE SCHOLARSHIPS. These are granted, under certain conditions, to pupils in the High Schools in the counties of Allegany, Steuben, Cattaraugus, Livingston and Wyoming, New York; and the counties of McKean, Potter and Tioga, Pennsylvania. They are limited to students fully prepared for college, and exempt the holders from payment of tuition and incidental fees, but require the payment in cash of the nominal sum of \$2 a year.

SCHOLARSHIPBENEFICIARIES 1900-1901

TEN PER CENT. SCHOLARSHIPS

College:

Daniel C. Babcock, Ashaway, R. I.	Archibald D. Jones, Whitesville
T. Coit Bliss, Alfred	Edith E. Kellett, Brooklyn
Otis B. Brainard, Dalton	Cash W. Miller, Wellsville
Mary A. Burdick, South Brookfield	Eugenia L. Marvin, Elmira
Dayton C. Clarke, Brookfield	D. F. Randolph, Alfred
O. Florence Cook, Cuba	Virginia K. Reed, Hornellsville
Herbert L. Cottrell, Hornellsville	Edith Swinney, Shiloh, N. J.
Albert B. Crandall, Ashaway, R. I.	Carl A. Sutliff, Addison
Althea Crandall, Ashaway, R. I.	Elizabeth Stillman, Alfred
Lynn B. Crandall, Milton Junction	Bertha E. Titsworth, Lake View, Cal.
Walter G. Davis, Shiloh, N. J.	Paul E. Titsworth, Alfred
Adalyn Ellis, Alfred	J. Fred Whitford, Nile
Yashimasa Ishikawa, Tokio, Japan	Raymond A. Withey, West Almond

Academy:

William H. Allen, Homer	Harry W. Langworthy, Alfred
Claude F. Austin, Alfred	Mary E. Langworthy, Alfred
Myrtle M. Austin, Alfred	Nellie S. Langworthy, Alfred Station
Alvin E. Babcock, Jackson Centre, O.	William N. Langworthy, Alfred
L. Emile Babcock, Jackson Centre, O.	Hattie O. Mattison, Plainfield, N. J.
Garrelt F. Bakker, Rotterdam, Holland	Alton R. Ormsby, Alfred Station
Jennie Bardeen, Elmira	Charles H. Palmer, Lavender, Ga.
G. Roy Brainard, Dalton	Sabella Randolph, Alfred
Otis Brainard, Dalton	Daniel B. Rogers, Alfred
James T. Brooks, Waterford, Conn.	Jessie Saunders, Alfred
Bertha O. Burdick, Alfred	Nellie A. Saunders, Alfred
Mary A. Burdick, South Brookfield	Ernst Schaible, Shiloh, N. J.
Emma K. Cartwright, Richburg	John E. Shannon, Alfred Station
Harry B. Case, Pompey	Leon I. Shaw, Alfred
Mabel E. Clarke, Alfred Station	Hoffman Simpson, Jackson Centre, O.
N. Celestia Crandall, Andover	Elizabeth Stillman, Alfred
James A. Craw, Honeoye, Pa.	Arthur E. Stukey, Alfred
Arthur M. Cottrell, Hornellsville	Chester R. Swinney, Shiloh, N. J.
Lorenzo C. Davis, Alfred	Helen A. Titsworth, Alfred
Theodore G. Davis, Shanghai, China	Paul E. Titsworth, Alfred
Wilburt Davis, Shiloh, N. J.	Wayland D. Wilcox, Lincklaen Center
John M. Gilbert, Alfred	Francis Williams, Adams Center
Arthur H. Hamilton, Ceres	Lela Wilson, Attala, Ala.
Ruth R. Hemphill, East Hebron, Pa.	Raymond A. Withey, West Almond
Clifford L. Henderson, Shiloh, N. J.	Agnes Whitford, Alfred Station
Gertrude B. Hoffman, Shiloh, N. J.	Arlie C. Whitford, Alfred
Myrtle B. Hull, Scio	Darwin M. Whitford, Hornellsville
Nathan S. Hull, Scio	Alton M. Young, Berlin

ONE THOUSAND DOLLAR SCHOLARSHIPS

<i>The First Seventh-day Baptist Church of Alfred</i>		
Helen Titsworth,	Alfred,	Academy
<i>The Ladies of Alfred,</i>		
Bertha E. Langworthy,	Alfred,	College
<i>The Shiloh Seventh-day Baptist Church and Society,</i>		
Gertrude B. Hoffman,	Shiloh, N. J.,	Academy
<i>The First Seventh-day Baptist Church of Plainfield,</i>		
Sydney R. Titsworth,	Plainfield, N. J.,	College
<i>The First Seventh-day Baptist Church of New York City,</i>		
H. Eugene Davis,	North Loup, Neb.,	College
<i>The Samuel N. Stillman,</i>		
Chloe Clarke,	Alfred,	Academy
Ford S. Clarke,	Alfred,	Church,
<i>The Ladies Aid Society of the Pawcatuck Seventh-day Baptist</i>		
Harold R. Crandall,	Providence, R. L.,	Academy
<i>The Alleghanian Lyceum,</i>		
Ernst Schaible,	Shiloh, N. J.,	Academy
<i>The Orophilian Lyceum,</i>		
Carl A. Sutliff,	Addison,	College
COMPETITIVE FREE SCHOLARSHIPS		Ceres
Robert S. Bell,		Ceres
Caroline Bell,		Dalton
G. Roy Brainard,		Cuba
Seymour B. Everts,		Nile
Henry N. Jordan,		Rush ford
Ruth H. Mason,		

TOTAL SCHOLARSHIP ALLOWANCES

ALFRED ACADEMY

TEN PER CENT. SCHOLARSHIPS:	99-00	00-01
The Thomas B. Stillman	\$192	\$323
All others	206	273
ONE THOUSAND DOLLAR SCHOLARSHIPS	121	115

COLLEGE OF LIBERAL ARTS

TEN PER CENT. SCHOLARSHIPS:		
The Thomas B. Stillman	159	130
All others	154	225
ONE THOUSAND DOLLAR SCHOLARSHIPS	28	142
COMPETITIVE FREE SCHOLARSHIPS	66	198

REPORTS, 1900-1901

DEGREES CONFERRED

June 27, 1901

BACHELOR OF PHILOSOPHY (In Course)

Albert B. Crandall,	Ashaway, R. I.
Ora L. Dennis,	Jasper
Adalyn J. Ellis,	Alfred
Louise K. Gamble,	Alfred
Eugenia L. Marvin,	Elmira
Muriel F. Rogers,	Brookfield

BACHELOR OF SCIENCE (In Course)

George M. Ellis,	Dodge Center, Minn.
Sydney R. Titworth,	Plainfield, N. J.

MASTER OF ARTS (On Examination)

Jay William Crofoot,	Shanghai, China
Judson G. Rosebush,	Alfred

DOCTOR OF LAWS (Honorary)

Abram Herbert Lewis, D. D.	Plainfield, N. J.
----------------------------	-------------------

Dr. Lewis was born at Scott, N. Y., in 1836, but soon removed with his parents to Wisconsin. He prepared for college at Ripon, Wis., and entered Milton College in 1857, from which he graduated in the classical course in 1861. Entering Alfred University in the autumn of that year, he was graduated here in the classical course in 1863, having done special work in Theological studies. Upon graduating from Alfred University he began his pastoral work and has had pastorates in Rhode Island, New York City, and New Jersey. While in New York City he pursued special post graduate studies in Church History in Union Theological Seminary. In 1868 he was elected to the chair of Church History and Homiletics at Alfred University which position he held, as resident and as non-resident professor, until 1892. His longest pastorate was the Seventh Day Baptist church of Plainfield, N. J., extending from 1880 until 1896, at which time he was called to the secretaryship of the American Sabbath Tract Society and editorship of the Sabbath Recorder, which positions he still occupies, giving to them the benefit of the rich experience of a thorough and tireless student. As author and editor his writings cover a large Historical and Theological field especially in the line of Sabbath Reform.

Henry Ellis Turner,	Lowville, N. Y.
---------------------	-----------------

Judge Turner was born of Puritan ancestry at Winchester, N. H., in 1832. His education was begun in the common schools and continued in Cope-land's Select school, in Clinton Liberal Institute and in Albany Law School. Upon being admitted to the Bar, he located at Lowville, N. Y.,

in 1856 and entered upon the practice of law. After serving his country during the civil war as captain and lieutenant colonel of volunteers, he served two terms as District Attorney of the County and during the years 1878 and 1879 he served the state as Senator from what was then the 18th Senatorial District. He is at present serving his fourth term as County Judge of Lewis County, N. Y. In February, 1881, the Legislature showed its appreciation of Judge Turner's judgment and worth in educational affairs by electing him as Regent of the University of the State, in which office he is rendering distinguished service to the educational interests of New York State.

Isaac H. Stout, A. M.,

Geneva, N. Y.

Prof. Stout has long been a well known educator in the state of New York. His early education was received in his native city, Geneva, N. Y. He served his country one year in the 61st N. Y. Vol., from which he was honorably discharged in 1865. He became connected the following year with the survey of the Kansas division of the Union Pacific R. R. Mr. Stout began his career as an educator by teaching in the public schools of New York State. After some fifteen years' experience as Principal in various High Schools and Academies of the state, he was elected School Commissioner of Seneca County. This position he held for six years. In September of 1887, he was appointed Conductor of Teachers' Institutes by Supt. A. S. Draper, and continued in that position until appointed Supervisor of Institutes, which position he now holds, March 15, 1898, by Supt. Charles R. Skinner. In these several positions, he has rendered distinguished service to the state and has proven himself an educator of rare talents and executive ability. The honorary degree of A. M. was conferred upon him by Hobart College, 1887, and by Hamilton College, 1893.

DOCTOR OF DIVINITY (Honorary)

David Herbert Davis, A. M., B. D.,

Shanghai, China

Mr. Davis was born and reared in Verona, Oneida Co., N. Y. He pursued Collegiate and Theological studies in Alfred University, graduating in the Classical course in 1873, and the Theological course in 1874. After completing his Theological studies he occupied for a short time the pastorate of the First Seventh-day Baptist Church at Verona, N. Y., and later the pastorate of the Shiloh Seventh-day Baptist Church at Shiloh, New Jersey. In 1880 he accepted an appointment as head of the Seventh-day Baptist Mission in Shanghai, China, which position he continues to hold. In this position he has been a most active and successful leader. Aside from the distinctively religious work of the Mission, he has given much attention to literary work. He is a member of the Shanghai Bible Translation Committee, and has translated much Christian literature from English into the Chinese language. He in connection with Mr. J. A. Sibley, has recently prepared and published a very important Chinese-English Dictionary.

Boothe Colwell Davis, M. A., B. D., Ph. D., Alfred

Pres. Davis was educated in the public schools of West Virginia, in the West Virginia State Normal School, in Alfred University, from which he graduated in 1890 with the degree of A. B., and in Yale University from which he received the degree of Bachelor of Divinity in 1893. Alfred University conferred the degree A. M. in 1893 for graduate courses in Philosophy taken at Yale. In 1897, the National Normal University of Ohio conferred upon him the honorary degree of Doctor of Philosophy. After graduation from Yale Pres. Davis was for two years the pastor of the First Seventh Day Baptist Church of Alfred. In 1895, he was elected to his present position as president of Alfred University. The degree was conferred for the University by the Rev. Dr. Ford of Elmira, the senior trustee of Alfred University, as a "surprise and mark of distinct and loving appreciation."

DOCTOR OF MUSIC (Honorary)

Arthur Mees, A. M.,

New York City

After a high school course in his native city, Columbus, O., Mr. Mees entered Concordia College, Fort Wayne, Ind. Upon graduation from Concordia, he attended courses of lectures at the Universities of Berlin and Leipzig. Returning to America, he was appointed teacher of Theory and lecturer on History of Music, at the Cincinnati College of Music, then under the direction of Theodore Thomas. On the departure of Mr. Thomas from Cincinnati, Mr. Mees became conductor of the Cincinnati Musical Festival Chorus. He was called to New York by Mr. Thomas to become assistant conductor of the American Opera. In New York, he has written the analytical programs of the Philharmonic Orchestra. He is also author of programs for the Chicago Orchestra, of which he has been assistant conductor. He recently published, at the request of Scribners Sons, a comprehensive work on Choirs and Choral Music, which has attracted much favorable comment and insures its author a place of high rank in the musical world.

MASTER OF SCIENCE IN CERAMICS (Honorary)

Charles Fergus Binns,

Alfred.

Prof. Binns is a native of Worcester, England, and received his early education at the Worcester Cathedral King's School and from private tutors. In 1872 he entered the Worcester Royal Porcelain Works and took up the study of Ceramic Science. During twenty-five years he superintended various branches of the manufacture and became familiar with every detail of the work. In 1897 he was appointed first principal of the School of Industrial Art at Trenton, N. J., and during his residence in that city he assisted in the superintendence of the Ceramic Art Co., and other important manufactories. In 1900 he was elected vice president and in 1901, president of the American Ceramic Society. In July, 1900, Prof. Binns was called to the position of Director of the New York State School of Clay-Working and Ceramics.

MASTER OF SCIENCE (Honorary)

Irving P. Bishop,

Buffalo

Prof. Bishop received his education at the New Berlin (N. Y.) Academy and at Cornell University. Upon leaving Cornell he began his educational work as principal of the New Berlin Academy. After eleven years' successful experience as principal in this Academy and in other academies and High Schools of the state he was appointed in 1888, Professor of Natural Science in the Buffalo State Normal school, which position he still fills most efficiently. Prof. Bishop has been teacher of Geology and of Science at various summer schools, and, with exception of one year while abroad on leave of absence, he has been Instructor in Science in the Chautauqua Summer Institute since its organization. He has done some work as lecturer and has done Institute work in Teachers' Institutes, both as instructor and as conductor for the last 14 years. He is also Fellow of the Geological Society of America. Prof. Bishop's principal publications are: Report on Salt Fields of Western New York, Geology of Erie County, New York; Petroleum and Natural Gas in Western New York ; and The Red Book of Niagara.

ALFRED ACADEMY

DIPLOMAS GRANTED

June 24, 1901

William H. Binns, Alfred	Emma K. Cartwright, Richburg
George A. Burdick, So. Brookfield	Arthur M. Cottrell, Hornellsville
Mary A. Burdick, So. Brookfield	Charles K. Marlatt, Jasper
Matilda Carlson, Olean	Merle A. Place, Ceres
George W. Post, Jr., Chicago	

TEACHERS' TRAINING CLASS

Maggie Bell, Ceres	Grace E. Goff, Almond
Ada Bonham, Shiloh, N. J.	Daniel H. Hall, Hallsport
Matilda Carlson, Olean	LaRoy Kenyon, Coudersport, Pa.
Mabel E. Clark, Alfred Station	Aimee L. McCarthy, Yonkers
S. Blanche Crandall, Alfred	Leila N. G. Palmiter, Oneida
Myrtie A. Evans, Portville	Nellie A. Saunders, Alfred
Charlotte E. Spencer, Jasper	

SEVENTH-DAY BAPTIST EDUCATION SOCIETY

(New York Corporation)

OFFICERS

PRESIDENT—Professor Edward M. Tomlinson, Alfred, N. Y.

CORRESPONDING SECRETARY—William L. Burdick, Independence, N. Y.

RECORDING SECRETARY—Terrence M. Davis, Alfred, N. Y.

TREASURER—Professor Alpheus B. Kenyon, Alfred, N. Y.

VICE-PRESIDENTS—William C. Whitford (Milton), Lewis A. Platts, Leander E. Livermore, Theodore L. Gardiner, Stephen Burdick, Albert Whitford, J. F. Shaw, Boothe C. Davis, J. Bennett Clarke, William C. Daland, Lorenzo D. Collins.

DIRECTORS—Elwood E. Hamilton, George H. Utter, William C. Burdick, David E. Titsworth, Henry M. Maxson, Ira B. Crandall (Alfred), William C. Whitford (Alfred), S. Whitford Maxson, Earl P. Saunders, Jesse F. Randolph, George J. Crandall.

THE ADVISORY COMMITTEE—George B. Shaw, A. B. Prentice, W. D. Burdick, Edwin Shaw, T. L. Gardiner, Charles S. Sayre.

ABSTRACT OF TREASURER'S REPORT

(August 22, 1900, to August 29, 1901.)

REVENUE AND EXPENDITURE

Interest on Bonds and Mortgages	\$ 2,184 95
Interest on Notes	82 07
Payments on Pledges for Theological Department of Alfred University	233 73
Annual Membership Fee, Rev. L. M. Cottrell	1 00
Total Receipts	\$ 2,501 75
<i>Cr.</i>	
Alfred University, Account of Biblical Languages	\$ 16 00
" " " " " Theological Department	46 50
" " " " " Natural History	12 00
" " " " " General Fund	2,093 36
American Sabbath Tract Society, for printing minutes, Expenses of Student Quartet	69 98
Printing, Postage, etc., Account of Theological Subscriptions	173 99
Printing, Postage etc., Account of General Fund	18 68
Accrued Interest on Bonds	11 85
Rent of Safety Deposit Box	2 33
Salary of Treasurer	2 00
Balance on hand, Account of Theological Subscription:	30 00
	24 06
Total Expenditures	\$ 2,501 75

PRINCIPAL ACCOUNT.

Dr.

Balance on hand August 22, 1900.....	\$ 1,123 43
Payment on Bonds and Mortgages.....	3,300 00
" " " Notes.....	1,100 00
" " Life Memberships, Orra S. Rogers.....	\$10 00—
" " " " W. H. Crandall.....	10 00—
" " " " G. H. Lyon.....	10 00—
" " " " Chas. Stillman.....	25 00—
" " " " M. Caroline Briggs.....	25 00—
" " " " George B. Utter.....	25 00—
" " " " Edwin G. Carpenter.....	25 00—\$130 00
Estate of Phineas C. Burdick, per J. Reed Burdick, Admr. for Theological Department of Alfred University...	663 40
Total.....	\$ 6,315 83

Cr.

Invested in Bonds.....	\$ 1,000 00
" " Notes.....	4,100 00
" " Stock.....	606 24
Balance on hand August 30, 1901.....	609 59
Total.....	\$ 6,315 33

CONDITION OF ENDOWMENT

Bonds and Mortgages.....	\$26,900 00
Stock.....	1,832 34
Notes.....	3,575 00
Old Endowment Notes.....	11,044 43
Cash.....	609 59
Total.....	\$43,961 34

ALFRED THEOLOGICAL SEMINARY

Maintenance and Endowment

At the ANNUAL MEETING of the SEVENTH-DAY BAPTIST EDUCATION SOCIETY at Adams Centre in 1900, the following report was presented by a committee which was appointed to consider the condition of the Theological Department at Alfred and make recommendations, viz:

1. In general, we heartily recommend that early and earnest effort be made by the Trustees of the University to strengthen the teaching force of that department, and that our people loyally and generously support these efforts.

2. That at least two professors, one of Theology and one of Biblical Interpretation be employed, but with an added one of History, if found practicable—who shall devote their time to the work and interests of the department.

3. That the labors of these professors be supplemented by the employment of non-resident lecturers on subjects in the line of the general aim of the department.

4. We commend to the favorable consideration of the Board of the Education Society the plan of securing individual and systematic subscriptions from our people for the benefit of the department, something after the method adopted by the Missionary Board.

This report was adopted. In compliance with the second recommendation, Rev. Arthur E. Main has been elected Dean of the Seminary and Professor of Doctrinal Theology and Pastoral Theology, and Rev. James Lee Gamble has been elected Professor of Church History and Homiletics. They have accepted their appointments, and entered upon the performance of their duties. Rev. William C. Whitford continues in the Professorship of Biblical Languages and Literature which he has held for a number of years. Rooms in the building known as the Gothic have been fitted up for the use of the Seminary.

THE COST of running the Seminary (as re-organized) for the year 1901-02, is estimated as follows:

Salaries	\$2,400
Fuel	100
Printing, traveling and incidental expenses, say.....	200
Repairs75
Furniture75
Total estimated expense	\$2,850

In this estimate nothing is included for the purchase of books nor for carrying into effect the third recommendation of the Committee. To maintain the Seminary in the manner contemplated by the recommendations will call for an expenditure of about \$3,000 a year, which equals the interest of \$60,000 invested at five per cent.

The Permanent Endowment of the Seminary at the time when the Committee presented its report was \$23,085.21, which yielded an income of \$1,031.06 in the fiscal year ending in 1900, as appears by the reports of the several corporations holding these funds in trust. (See "Schedule A" below.) Thus, something over \$1,800 more was required to provide for the expenses of the Seminary for the College Year 1901-02.

In compliance with the fourth recommendation of the Committee, Rev. Lester C. Randolph of the First Seventh-day Baptist Church of Alfred, aided by the Alfred Quartet No. 1, made a canvass of many churches of the Denomination, in the summer of 1901, and secured between 500 and 600 pledges toward the maintenance of the Seminary. The number of pledges secured indicates the general interest of the people in the matter, and that they "loyally and generously support the efforts " to strengthen the department. (See " Schedule B " below.)

Since the Reports of 1900 were made, the permanent endowment funds have been increased by a bequest from Phineas C. Burdick, deceased, and by gifts and pledges amounting, in the aggregate to \$12,988.40. (See "Schedule C" below.) Of this amount \$10,725 was secured at the General Conference at Alfred in 1901, by the earnest efforts of Messrs. David E. Titsworth, Charles C. Chipman and Orra S. Rogers, which has since been augmented by pledges amounting to \$650 00.

Schedule A.

Funds held in trust for the benefit of the Theological Seminary as shown by the Annual Reports in 1900, together with the income reported for the year covered by the reports:

<i>Plainfield Professorship of Doctrinal Theology:</i>	Amount	Income
Board of Trustees of the Seventh-day		
Baptist Memorial Fund	\$11,017 01	\$ 416 81
Alfred University	100 00	
<i>Nathan V. Hull Professorship of Pastoral Theology:</i>		
Alfred University	3,579 20	141 30
Board of Trustees of the Seventh-day		
Baptist Memorial Fund	50 00	1 23
<i>Professorship of Church History and Homiletics:</i>		
Board of Trustees of the Seventh-day Baptist		
Memorial Fund	6,665 00	411 72
(Income invested, (\$700)		
Alfred University	550 00	13 50
<i>Theological Department (generally)</i>		
Seventh-day Baptist Education Society	1,124 00	46 50
	\$23,085 21	\$1,031 06

Schedule B.

SUMMARY OF SUBSCRIPTIONS for MAINTENANCE, to be paid in equal monthly payments during the year, to which is added the collections taken at the Annual Meetings of the Education Society and of Conference in 1901.

Waterford	Connecticut	\$ 30 20
New Market	New Jersey	49 28
Plainfield	"	272 20
Adams Centre	New York	94 20
Alfred	"	460 20
Berlin	"	86 45
Brookfield	"	54 00
Independence	"	26 55
Leonardsville	"	81 00
New York City	New York	80 20
West Edmeston	"	24 00
Ashaway	Rhode Island	121 20
Dunn's Corners	"	17 40
Niantic	"	5 80
Rockville	"	10 20
Westerly	"	125 60
Milton Junction	Wisconsin	52 40
Miscellaneous Places		36 60
Collections, viz:		
Education Society, Annual Meeting, 1901		76 70
Conference, 1901, one-third of collection		82 50
Total		\$1,780 60

Schedule C.

ADDITIONS TO PERMANENT ENDOWMENT FUND OF THE SEMINARY by bequest, gift and pledge since the Annual Reports were made in 1900.

Dr. Emerson W. Ayars	Richburg, N. Y.	\$100 00
Mrs. George H. Babcock	Plainfield, N. J.	500 00
Herbert Babcock	Ashaway, R. I.	100 00
Stephen Babcock	New York City	100 00
Vernon A. Baggs	Alfred	100 00
Mr. and Mrs. Samuel F. Bates	New York City	100 00
Mrs. Abby W. Berry	Independence, N. Y.	100 00
Winfield S. Bonham	Shiloh, N. J.	100 00
Mrs. Asa S. Briggs	Ashaway, R. I.	525 00
Edward W. Burdick	West Hallock, Ill.	100 00
D. Sherman Burdick	Alfred	100 00
Mr. and Mrs. George N. Burdick	Potter Hill, R. I.	100 00
L. E. Burdick	Antioch, Cal	100 00
Phineas C. Burdick (deceased) bequest, DeRuyter, N. Y.		663 40
Susie M. Burdick	Alfred	125 00
Mr. and Mrs. Lewis Canfield	Scio, N. Y.	100 00
Hon. George B. Carpenter for		
Edwin Grant Carpenter	Ashaway, R. I.	25 00
Hon. Albert L. Chester	Westerly, R. I.	100 00
Charles C. Chipman	New York City	100 00
Charles W. Clarke	Ashaway, R. I.	100 00

Rev. J. Bennett	Clarke.....Alfred	100 00
Kate M. Clarke	New York City.....	100 00
Hon. William L. Clarke	Ashaway, R. I.....	100 00
Mrs. William L. Clarke	Ashaway, R. I.....	100 00
Will R. Clarke	New York City.....	100 00
Hon. Albert B. Cottrell	Alfred.....	100 00
John B. Cottrell	New York City.....	100 00
Royal L. Cottrell	New York City.....	100 00
Mr. and Mrs. Libeus B. Coon	Little Genesee, N.....	100 00
H. J. Coon	Walworth, Wis.....	25 00
Ira B. Crandall	Westerly, R. I.....	50 00
Hannah Crandall	Westerly, R. I.....	25 00
Maxson A. Crandall	Independence, N. Y.....	100 00
Sherman G. Crandall	Independence, N. Y.....	100 00
Mr. and Mrs. William H. Crandall	Alfred.....	100 00
Will R. Crandall	Independence, N. Y.....	100 00
Frank A. Crumb	Alfred.....	100 00
Mandane M. Crumb	Walworth, Wis.....	100 00
Pres. Boothe C. Davis	Alfred.....	100 00
William M. Davis	Chicago, Ill.....	100 00
Mrs. Mary L. W. Ennis	Westerly, R. I.....	25 00
Pres. Theodore L. Gardiner	Salem, W- Va.....	100 00
David I. Greene	Hartford Conn.....	100 00
Prin. Frank L. Greene	New York City.....	100 00
George A. Greenman	Westerly, K. I.....	100 00
O. DeGrasse Green	Adams Centre, N. Y.....	100 00
Orson C. Greene	Alfred.....	100 00
Orville D. Greene	Syracuse, N. Y.....	100 00
Elwood E. Hamilton	Alfred.....	100 00
Mr. and Mrs. Freeborn W. Hamilton	Alfred Station, N. Y.....	100 00
Rev. George W. Hills	Nortonville, Kan.....	100 00
Hon. Frank Hill	Ashaway, R. I.....	100 00
James W. Hoard	Alfred.....	100 00
Charles B. Hull	Chicago, Ill.....	100 00
Eugene Hyde	Nile, N. Y.....	100 00
Frank J. Hubbard	Plainfield, N. J.....	100 00
Capt. J. Frank Hubbard	".....	675 00
Mrs. J. Frank Hubbard	".....	100 00
Joseph A. Hubbard	".....	100 00
Mr. and Mrs. William C. Hubbard	".....	100 00
James R. Jeffrey	Elmdale, Kan.....	100 00
Rev. M. Bartley Kelly	Chicago, Ill.....	25 00
Prof. Ida F. Kenyon	Alfred.....	100 00
Mrs. William W. Kingsbury	Rushford, N. Y.....	25 00
G. H. Lyons	Ormsby, Pa.....	100 00
Anna F. Maltby	New York City.....	100 00
Daniel C. Main and	".....	100 00
George A. Main	Plainfield, N. J.....	100 00
Supt. Henry M. Maxson	".....	100 00
Mrs. Henry M. Maxson	".....	100 00
Mr. and Mrs. Holly W. Maxson	New York City.....	100 00
Rev. S. Lafayette Maxson	Walworth, Wis.....	100 00
S. Whitford Maxson	Adams Centre, N. Y.....	25 00
Mrs. Leona Merrill	Albany, N.....	100 00
Rev. N. M. Mills	Dunns Corners, R. I.....	100 00
Milton Quartet per	".....	
Rev. George W. Hills	".....	

APPENDIX A

61

Dr. Rosa Palmborg	Shanghai, China	25 00
Jonathan H. Palmiter	Albion, Wis	100 00
Harriet A. Pierce	Carbondale, Pa	100 00
Dr. Charles M. Post	Alfred	100 00
Mrs. Charles Potter	Plainfield, N. J.	100 00
Rev. Asa B. Prentice	Adams Centre, N. Y.	100 00
Lily LaForge Prentice	New York City	100 00
Rev. Lester C. Randolph	Alfred	2500
Calvin D. Reynolds	"	100 00
Mrs. Calvin D. Reynolds	"	25 00
Sophie Reynolds	"	25 00
Mrs. Mary E. Rich	Tampa, Fla	100 00
Adelia Robinson	Shiloh, N. J.	100 00
Orra S. Rogers	Plainfield, N. J.	125 00
Dr. and Mrs. Thomas Rogers	New London, Conn	100 00
Mrs. John E. B. Santee	Hornellsville, N. Y.	100 00
Caroline B. Saunders	Alfred	100 00
Irving Saunders	Rochester, N. Y.	100 00
Mrs. Albert R. Shepard	Chicago, Ill	100 00
Mizpah Z. Sherburn	Chicago, Ill	5000
Rev. Oliver D. Sherman	Mystic, Conn	125 00
Mrs. Oliver D. Sherman	Mystic, Conn	25 00
Charles Stillman	Alfred	25 00
Rev. Mazzini G. Stillman	Lost Creek, W. Va	100 00
Dr. Ella F. Swinney (deceased) about	Residue of estate of	100 00
Colin H. Threlkeld	Memphis, Tenn	100 00
Silas S. Thomas	Milton, Wis	100 00
David E. Titsworth	Plainfield, N. J.	100 00
Mrs. David E. Titsworth	"	100 00
Joseph M. Titsworth	"	100 00
Rev. Theodore J. Van Horn	Brookfield, N. Y.	25 00
Alexander W. Vars	Dunellen, N. J.	100 00
Hon. George H. Utter for		
George B. Utter	Westerly, R. I.	25 00
Lucius D. Walker	Leonardsville, N. Y.	100 00
Frank J. Wells	Milton, Wis	100 00
Dr. Frank S. Wells	Plainfield, N. J.	100 00
Prin. Edward E. Whitford	Brookfield, N. Y.	25 00
Mrs. Edward E. Whitford	Brookfield, N. Y.	25 00
Prof. William C. Whitford	Alfred	100 00
Mrs. William C. Whitford	Alfred	100 00
Ellen A. Williams	Richburg, N. Y.	100 00
Mr. and Mrs. William E. Witter	Oneida, N. Y.	500 00
Charles J. York	DeRuyter, N. Y.	100 00

Total

\$12,988 40

BOARD OF TRUSTEES OF THE SEVENTH-DAY BAPTIST MEMORIAL FUND

(New Jersey Corporation)

TRUSTEES ELECTED BY THE SEVENTH-DAY BAPTIST GENERAL CONFERENCE

J. Frank Hubbard,	1899	Plainfield
Joseph M. Titsworth,		Plainfield
J. Dennison Spicer,		Plainfield
William M. Stillman,	1900	Plainfield
Henry V. Dunham,		Dunellen
Clarke T. Rogers,		Dunellen
Joseph A. Hubbard,	1901	Plainfield
Henry M. Maxson,		Plainfield
David E. Titsworth,		Plainfield

TRUSTEES EX-OFFICIO

J. Dennison Spicer,	Treasurer of American Sabbath Tract Society
William H. Crandall,	" Alfred University
Albert Whitford,	" Milton College
George H. Utter,	" The Seventh-day Baptist Missionary Society

OFFICERS

PRESIDENT,	J. Frank Hubbard
VICE PRESIDENT,	Joseph M. Titsworth
TREASURER,	Joseph A. Hubbard
SECRETARY,	David E. Titsworth

FUNDS HELD IN TRUST FOR THE BENEFIT OF ALFRED UNIVERSITY

(Abstract of Report, July 1, 1900, to July 1, 1901)

PLAINFIELD PROFESSORSHIP OF DOCTRINAL THEOLOGY.

Mortgages	\$3,500 00	
Bonds	1,800 00	
Bank stock	1,000 00	
Real estate, 2 houses and lots, Plainfield, N. J.,	3,800 00	
Deposited in Dime Savings Institution.917 01—	\$11,017 01

2. BABCOCK PROFESSORSHIP OF PHYSICS			
Mortgages	9,900	00	
Bonds	881	50	
Bank stock	6,050	00	
Real estate, Plainfield, N. J.	3,288	72	
Deposited in Dime Savings Institution	364	93—	20,485 15
3. WILLIAM B. MAXSON PROFESSORSHIP OF GREEK LANGUAGE AND LITERATURE.			
Mortgages	6,500	00	
Bonds	3,500	**—	10,000 00
4. PROFESSORSHIP OF CHURCH HISTORY AND HOMILETICS.			
Mortgages	6,650	00	
Cash	15	00—	6,665 **
5. PROFESSORSHIP OF PASTORAL THEOLOGY.			
Deposited in Dime Savings Institution			50 00
6. ALFRED UNIVERSITY.			
Deposited in Dime Savings Institution			212 50
7. CHARLES POTTER PROFESSORSHIP OF HISTORY AND POLITICAL SCIENCE.			
Mortgages	17,650	00	
Bonds	7,500	00	
Bank stock	2,149	00	
Notes	1,500	00	
Deposited in Dime Savings Institution	82	44—	28,881 44
8. *GEORGE H. BABCOCK FUND			
			50,302 54
9. *E. L. BABCOCK FUND			
			20,121 02
TOTAL			\$147,734 66

*THESE ENDOWMENT FUNDS were provided for in the will of the late **GEORGE H. BABCOCK**, of Plainfield, N. J., Section Twenty-four, Subdivisions seventh, eighth and ninth, as follows:

SECTION TWENTY-FOUR. Out of the residue and remainder of my estate, real and personal, I give, devise and bequeath to the "**BOARD OF TRUSTEES OF THE SEVENTH-DAY BAPTIST MEMORIAL FUND**," a duly incorporated body, located in the City of Plainfield, N. J., and its successors, forever, the sum of two hundred thousand dollars in cash, or in such property owned by me after the above bequests have been provided for, as they may elect to take at their appraised value, the same to be by them invested and kept invested, and the net income therefrom to be used as follows:

Seventh: If there be sufficient income from the fund, I do order and direct that a sum not exceeding the income upon ten thousand dollars shall be paid by them as occasion may offer for the purpose of *aiding young people (male or female) in preparing for the Gospel Ministry in the Seventh-day Baptist Denomination.*

Eighth: I do order and direct that the income received from twenty thousand dollars shall be paid to the **TRUSTEES OF ALFRED UNIVERSITY**, to be known as the "**E. L. BABCOCK FUND**," the same to be applied by said trustees in keeping the grounds in good order and repair and for the purpose of inculcating ideas and habits of order and neatness among the students.

Ninth: I do order and direct that the income received from fifty thousand dollars shall be paid to the **TRUSTEES OF ALFRED UNIVERSITY** to be used by them for such purposes as they shall deem best.

These funds are invested as follows:

Mortgages	\$18,700 00
Bonds	9,000 00
Capital Stock, of the Babcock & Wilcox Co. Ltd.	122,500 00
Bank stock	10,701 00
Deposited in Dime Savings Institution	895 24
Real Estate, viz:	
Two vacant lots, Lock Arbor, N. J.	\$5,000 00
House and 6 acres of land, Jacksonville, Fla,	2,500 00
Houses and lots, Plainfield, N. J.	31,913 94— 39,413 94
	\$201,210 18

FUNDS HELD IN TRUST FOR THE BENEFIT OF EDUCATIONAL INSTITUTIONS

10. *GEORGE H. BABCOCK FUND TO AID YOUNG PEOPLE PREPARING FOR THE MINISTRY.	\$10,060 51
11. BI-CENTENNIAL EDUCATION FUND.	
Mortgages	\$3,850 00
Bonds	2,500 00
Deposited in Dime Savings Institution113 98— 6,463 98

INCOME PAID TO ALFRED UNIVERSITY DURING TEN YEARS

Year	1	2	3	4	5	6
1892	426 71	1,092 00	463 16	307 00	17 25	12 00
93	513 87	1,241 50	405 00	225 00	6 00	12 00
94	413 08	926 00	466 17	100 00	6 00	
95	405 58	1,018 60	749 71	700 00		12 00
96	513 95	1,116 80	630 00	651 06		24 00
97	367 25	2,134 05	417 66	225 00		12 00
98	272 81	1,071 84	53 90	535 68	5 4i	14 85
99	429 98	270 59	335 06	482 52	2 90	11 77
1900	416 81	1,570 02	332 69	411 72	1 23	663
1901	373 48	1,087 61	154 84	429 48	1 25	5 35
	4,133 52	11,529 01	4,008 19	4,067 46	40 04	110 60
	7	8	9	10	11	
1892	1,000 00					
93	1,000 00					
94	1,000 00					
95	1,000 00					
96	1,000 00					
97	292 02	4,000 00	1,600 00	200 00		
98	468 90	2,899 95	1,159 98	193 33	61 24	
99	952 23	4,228 30	1,691 32	200 00	100 00	
1900	1,257 22	3,786 73	1,514 69	461 00	60 81	
1901	1,331 47	4,407 09	1,762 84	279 01	121 02	
	9,301 84	19,322 07	7,728 83	1,333 34	343 07	



WESTON FLINT, A. M., PH. D., LL. D.
President of the Alumni Association, 1900-1901

WESTON FLINT, A. ML, Ph. D., LL. D.

Immediately after graduating at Alfred, Mr. Flint entered Union College from which he graduated in 1860, with the degree of Bachelor of Arts. In 1863 Union College gave him the Master's Degree. In 1877-78 he attended the Law Department of the National University at Washington, D. C, and the following year, the Law School of the Columbian University. He received the degree of Bachelor of Laws from the National University; and Master of Laws from Columbian University. In 1886, Alfred University conferred upon him the degree of Doctor of Philosophy, and in 1900 the Degree of Doctor of Laws. In 1862-65, he was Ohio State Military Agent at St. Louis; 1866-70, he was Secretary of the Geological Survey of Missouri; in 1864-70. he was Editor and Publisher of St. Louis Daily Tribune; 1871-74, U. S. Consul to China; 1877-88, Librarian of the Scientific Library of the Patent Office, publishing two complete catalogues of the Library, also 1878-83, Chairman of the Board of U. S. Civil Service Examiners; 1888-89, Clerk in the United States Senate; 1889-93, Statistician of the U. S. Bureau of Education, preparing also the special report on Libraries of the United States and Canada; 1896, Secretary of the Anthropological Society, and also Secretary of the American Statistical Society, Washington, D. C. Since 1898 he has been Librarian of the Public Library of the District of Columbia. In June, 1900, he was elected President of the Alumni Association of Alfred University. Address: The Westover, Washington, D. C.

ALUMNI ASSOCIATION OF ALFRED UNIVERSITY

(New York Corporation.)

This Society includes all graduates of the University, all persons who have received degrees from it, members of the Faculty, and former students who have been in attendance for one year or more. The annual fee is one dollar.

The objects of the Society are to foster fraternal intercourse and sympathy, and the interest of its members in their Alma Mater, as well as to promote the welfare of Alfred University.

At the time of its organization in 1886, the Society established a perpetual fund for the benefit of the University, giving it the name of the KENYON-ALLEN ENDOWMENT FUND. This fund now amounts to upwards of \$10,000. The Society has adopted a form of pledge to pay, for the benefit of the fund, one dollar a month for five years; and a considerable amount has already been secured in this manner. Pledges or contributions in cash are solicited, and will be duly acknowledged and added to the fund. The income of the fund is used, in part to defray the expenses incident to a course of lectures annually before the University, and in part to assist in the payment of the salary of the President.

The Society is represented on the Board of Trustees of the University by nine trustees, three of whom are elected each year for a term of three years.

The Annual Meeting of the Society is held on Wednesday of Commencement Week, the whole day being given over to the Society.

BOARD OF DIRECTORS

Hon.	Daniel Beach, Ph. D., LL. D., '56, President,	Corning.
Prof.	Alpheus B. Kenyon, S. M., '74, Vice President,	Alfred.
Prof.	William C. Whitford, A. M., Secretary,	Alfred.
	Elwood E. Hamilton, Ph. B., '84, Treasurer,	Alfred.
Hon.	Isaac B. Brown, LL. D., '69,	Harrisburg, Pa.
Hon.	Weston Flint, Ph. D., LL. D., '58,	Washington, D. C.
Prof.	Edward M. Tomlinson, A. M.	Alfred.
	William H. Crandall, Esq., ('62-'63)	Alfred.
Hon.	Nathaniel M. Hubbard, Ph. D., LL. D., '52,	Cedar Rapids, Iowa.
Prin.	Earl P. Saunders, A. M., '80,	Alfred.
	Theodore S. Hubbard, Ph. M., '64,	Geneva.
	D. Sherman Burdick, Ph. B., '82,	Alfred.
Hon.	Daniel Lewis, Ph. D., M. D., '69,	New York City.

EXECUTIVE COMMITTEE

Messrs. E. M. Tomlinson, E. P. Saunders, and W. H. Crandall, and Officers, *Ex-Officio*.

ENDOWMENT FUND COMMITTEE

Daniel Lewis, Chairman, W. H. Crandall, Theodore S. Hubbard, and the Officers, *Ex-Officio*.

LECTURE COMMITTEE

Messrs. B. C. Davis, E. M. Tomlinson, J. N. Davidson.

LIBRARY DIRECTOR

Herbert G. Whipple.

UNIVERSITY TRUSTEES

REPRESENTING ALUMNI

		Term expires
Hon.	Nathaniel M. Hubbard, Ph. D., LL. D., '52, Cedar Rapids, Iowa.	1902
	Chas. Clarence Chipman, Acct. B., '86,	New York City.
Hon.	John N. Davidson, E. M., '54,	Wiscoy.
Hon.	Daniel Lewis, A. M., Ph. D., M. D., '69,	New York City. 1903
Hon.	Seymour Dexter, A. M., Ph. D., '64,	Elmira.
	John J. Merrill, Ph. B., '84,	Alfred.
Hon.	Albert B. Cottrell, [59-60]	Alfred. 1904
Rev.	Oscar U. Whitford, A. M., D. D., '63,	Westerly, R. I.
Prin.	Corliss F. Randolph, A. M. '88,	Plainfield, N. J.

CANDIDATES FOR THE BOARD OF TRUSTEES OF
THE UNIVERSITY

FOR THE TERM BEGINNING IN JUNE, 1902

Hon.	J. Ernest B. Santee, ('66-'67)	Hornellsville.
Judge	N. M. Hubbard, Ph. D., LL. D. '52,	Cedar Rapids, Iowa.
Prof.	Darius R. Ford, D. D., <i>US</i> :	Elmira.
	Clarence C. Chipman, Acct. B. '86,	New York.
Prof.	Alfred A. Titsworth, C. E., M. S., ('69-'70)	New Brunswick, N. J.
	D. Sherman Burdick, Ph. B. '82,	Alfred.
Dr.	Leman W. Potter, M. D., Ph. M., '76,	Homer.
Dr.	Alfred C. Prentice, A. M., M. D., '97,	New York.
Hon.	Milo M. Acher, ('76-'77)	Hornellsville.

TREASURER'S REPORT

15th Annual Report for year ending June 24, 1901

GENERAL FUND

Dr.	
Balance on hand at last report	\$94 84
Banquet Committee for 1900 (Proceeds of 148 covers) —	7 54
Membership Fees and Dues	65 00
Transferred from Interest by vote of Directors	200 00— \$367 38
Cr.	
Repaid Loan from Principal Fund	200 00
Paid on orders:	
Sua Publishing Association, printing	16 20
University Bank, rent of safe deposit box	2 00
A. B. Kenyon, expenses of lecture Rev. T. L. Gardiner.	29 50
W. C. Whitford, postage	6 00—\$253 70
Balance on hand	\$113 68

KENYON-ALLEN ENDOWMENT FUND

INCOME ACCOUNT

Dr.	
Balance on hand, last report	\$549 70
Interest on bond and mortgage investments	419 5
Interest on Endowment Notes	213 65
	\$1,182 50
Cr.	
Transferred to General Fund	\$200 00
Paid Accrued Interest on Mortgage Invested	8 10
Paid Treasurer of Alfred University	500 — 70 00
Balance on hand	\$474 40

PRINCIPAL ACCOUNT

Dr.	
Balance on hand at last report	\$149 59
Loan to General Fund repaid	200 00
Bond paid	400 00
Monthly Pledges paid	170 00
Endowment Notes paid	2010 00
Cash subscriptions received	2 00
	\$2,931 59
Cr.	
Invested in Bonds and Mortgages	\$2,650 00
Balance on hand uninvested	\$281 59

CONDITION OF ENDOWMENT

Bond and Mortgage Investments	\$8,055 00
Endowment Notes considered good	1,289 00
" doubtful	295 00
Monthly Pledges	190 00
Cash on hand uninvested	281 59

KENYON-ALLEN ENDOWMENT FUND \$10,110 59

Respectfully submitted,
E. E. HAMILTON, Treasurer,

NEW YORK STATE SCHOOL OF CLAY- WORKING AND CERAMICS

BOARD OF MANAGERS

(University Trustees)

PRESIDENT BOOTHE COLWELL DAVIS,

WILLIAM H. CRANDALL,

JOHN J. MERRILL,

ELWOOD E. HAMILTON,

WILL R. CLARKE.

The following is a copy of Chapter 383 of the Session Laws of New York, 1900:

An Act to establish a State School of Clay-Working and Ceramics at Alfred University, and making appropriation for the construction and equipment of a suitable building, and the maintenance of such school for one year.

Section 1. There is hereby established a state school of clay-working and ceramics at Alfred University. For the purpose of constructing and equipping a suitable building for such school at Alfred, New York, the sum of fifteen thousand dollars, or so much thereof as may be necessary, is hereby appropriated to be paid by the treasurer, upon the warrant of the comptroller, upon vouchers approved by the state architect, to Alfred University. No part of such moneys shall be expended until the plans and specifications for the construction and equipment of such building and the location thereof shall be approved by the state architect, nor until the comptroller shall have certified that in his judgment the expense of the completion and equipment of such building in accordance with such plans and specifications will not exceed the amount of such appropriation. Such building and equipment shall be the property of the State. There shall be no tuition charged to students residents of this state for instruction in the school hereby established.

Section 2. For the maintenance for one year of said state school of clay-working and ceramics, the sum of five thousand dollars, or so much thereof as may be necessary, is hereby appropriated out of moneys in the treasury not otherwise appropriated, payable to the treasurer of Alfred University, on the warrant of the comptroller.

Section 3. This act shall take effect immediately.

In accordance with the above act the building has been constructed and equipped as indicated below, and the school registered for its first year, 1900-1901, eight students.

BUILDING

Advertising forbids, inspection, etc.	\$	73	48	
Gillingham & Son. Contractors.....		10,922	00	
Celadon Roofing Tile Co., Tile Roof and Trimming.		600	00	\$11,595 48

EQUIPMENT

Clay mixing and filtering outfit	\$	800	00	
Improved Centennial Brick Machine	406		'5	
Dry pan		357	50	
Pug mill		260	00	
Otto gas engine		965	00	
Cage for small cylinders			00	
Potter's steam lathe		100	00	
Potter's foot lathe		90	00	
Potter's hand jigger		40	00	
Revelation kiln.....		95	00	
Parcell mill and balls.....	11		50	
Thrower's wheel		90	00	
Jigger head		8	50	
Jigger ring		3	13	
Silk and wire lawn		36	66	
Shafting, castings and labor.....	36		00	
Lumber.....		4	88	\$ 3,404 52
				\$15,000 00

EXPENDED BY ALFRED UNIVERSITY

Lot for building	\$1,000	00	
Belting, shafting, etc.	34	90	
Plumbing for water.....	157		30
Piping for gas.....	14		00
Sundries	169	00	\$ 1,400 00

UNIVERSITY OF THE STATE OF NEW YORK

Regents

ANSON JUDD UPSON, D. D., LL. D., L. H. D., Chancellor.
 WILLIAM CROSWELL DOANE, D. D., LL. D., Vice Chancellor.
 BENJAMIN B. ODELL JR., Governor.
 TIMOTHY L. WOODRUFF, M. A., Lieut, Governor.
 JAMEST, MCDONOUGH, LL. D., Secretary of State, [*Ex-officio*>
 CHARLES R. SKINNER, M. A., LL. D., Superin-
 tendent of Public Instruction.

YEAR.	In order of election by Legislature.	
1873	MARTIN I. TOWNSEND, M. A., LL. D.,	Troy
1874	ANSON JUDD UPSON, D. D., LL. D., L. H. D.,	Glens Falls
1877	CHAUNCEY M. DEPEW, LL. D.,	New York
1877	CHARLES E. FITCH, LL. B., M. A., L. H. D.,	Rochester
1877	ORRIS H. WARREN, D. D.,	Syracuse
1878	WHITELAW REID, LL. D.,	New York
1881	WILLIAM H. WATSON, M. A., M. D.,	Utica
1881	Henry E. TURNER,	Lowville
1883	STCLAIR MCKELWAY, LL. D., L. H. D., D. C. L.,	Brooklyn
1885	HAMILTON HARRIS, Ph. D., LL. D.,	Albany
1885	DANIEL BEACH, Ph. D., LL. D.,	Watkins
1888	CARROLL E. SMITH, LL. D.,	Syracuse
1890	PLINY T. SEXTON, LL. D.,	Palmyra
1890	T. GUILFORD SMITH, M. A., C. E., LL. D.,	Buffalo
1892	WILLIAM CROSWELL DOANE, D. D., LL. D.,	Albany
1893	LEWIS A. STIMSON, B. A., M. D.,	New York
1895	ALBERT VANDER VEER, M. D., Ph. D.,	Albany
1897	CHESTER S. LORD, M. A., LL. D.,	Brooklyn
1900	THOMAS A. HENDRICK, M. A.,	Rochester

Elected by the Regents,

1900	JAMES RUSSELL PARSONS, Jr., M. A., Secretary,	Albany
------	---	--------

DIRECTORS OF DEPARTMENTS

1888	MELVIL DEWEY, M. A., State Library and Home Education,	Albany
1890	JAMES RUSSELL PARSONS, M. A., Administrative, College, and High School,	Albany
1900	FREDRICK J. H. MERRILL, Ph. D., State Museum,	Albany